

GROUP 16 - PROPELLER SHAFT AND UNIVERSAL JOINT

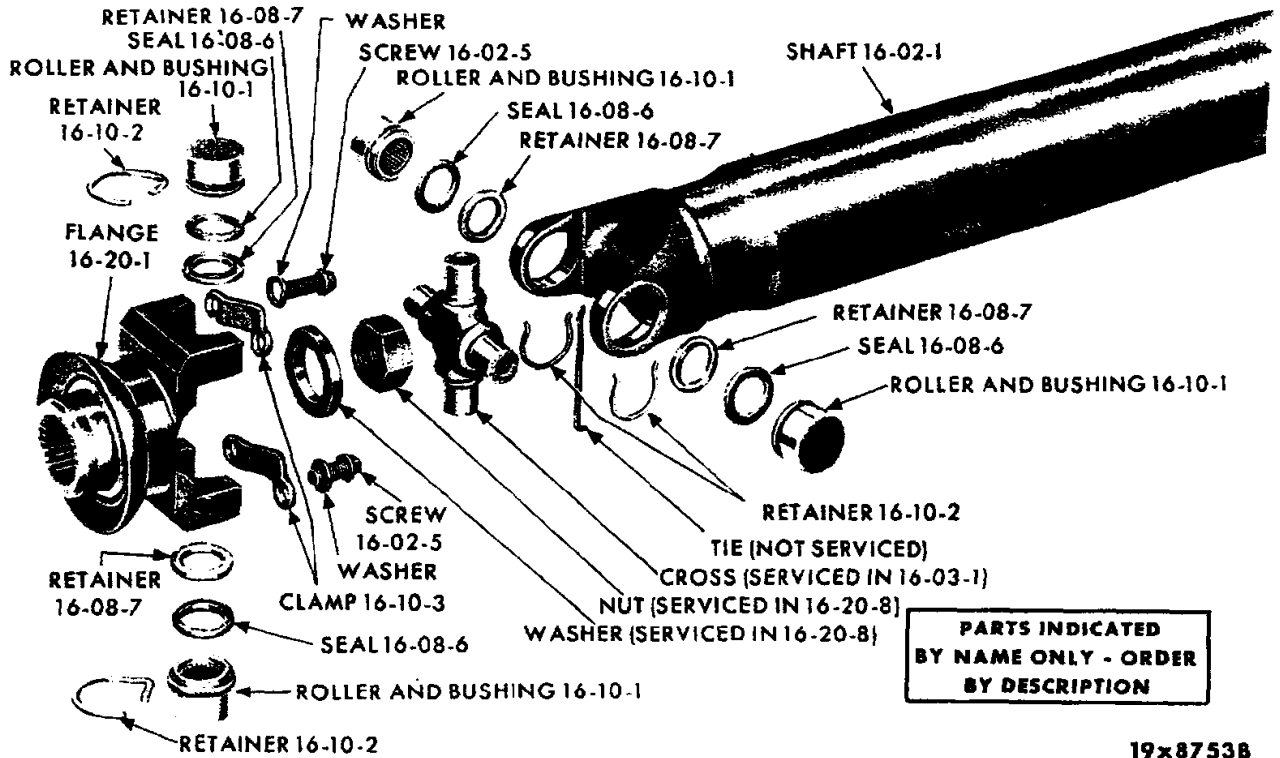

19x8753B

PROPELLER SHAFT - AXLE END

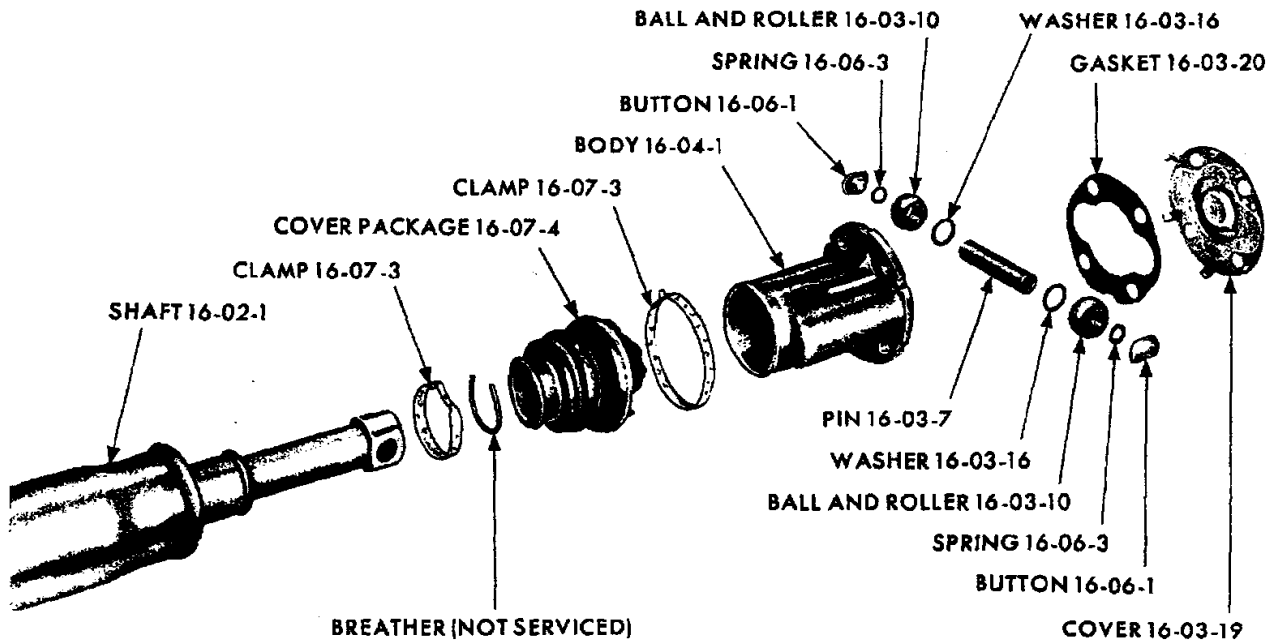

19x8752

PROPELLER SHAFT - TRANSMISSION END

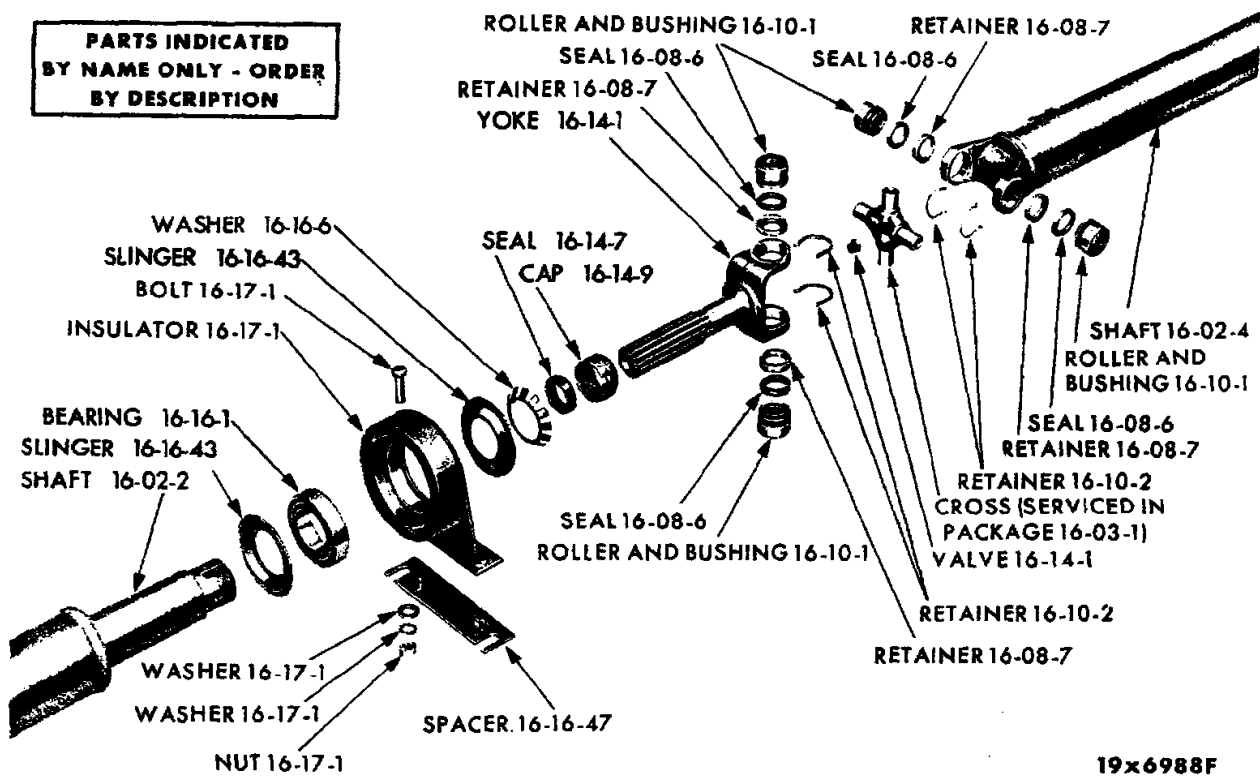

PROPELLER SHAFT CENTER BEARING - IMPERIAL VY1

NOTES

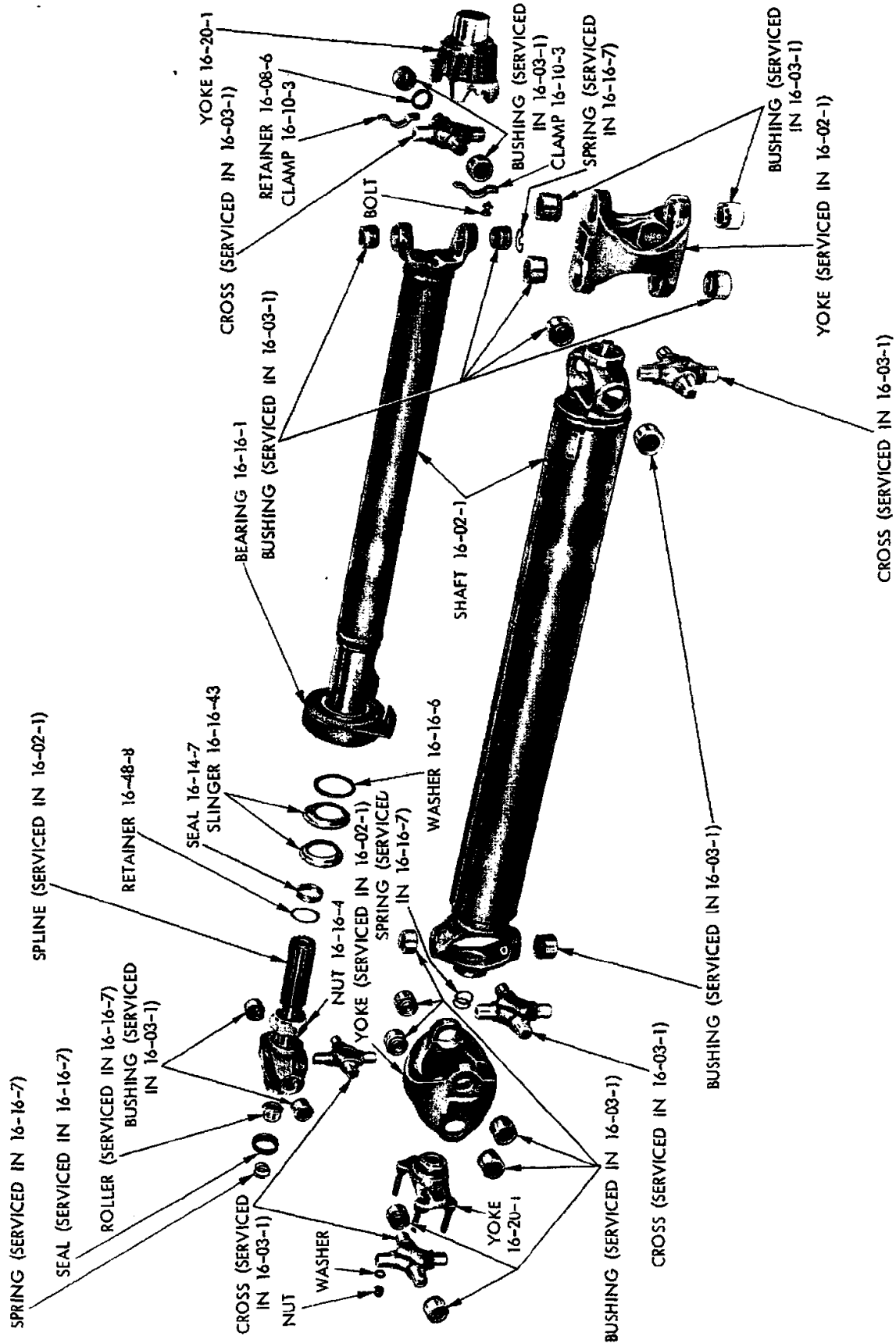

19A0179

PROPELLER SHAFT CENTER BEARING - IMPERIAL VY1 (AFTER TYPE)

CODE	PART NAME AND DESCRIPTION	CYL	PER CAR	VALIANT DART	PLYMOUTH DODGE	CHRYSLER IMPERIAL
------	---------------------------	-----	---------	--------------	----------------	-------------------

16-02-0 PROPELLER SHAFT

NOTE 1: When it becomes necessary to service Propeller Shafts or Front Universal Joints on cars equipped with the 426 Cubic Inch Maximum Performance Engine and All V8 Engine Police Cars, it is Recommended that the Shaft be Replaced as A Complete Assembly.

NOTE 2: Length measurement of Shafts are from Center of Pin hole Trans. End to Center of Bearing hole Axle End.

NOTE 3: Serial No. 156671 Plymouth Built, 145208 Dodge Built, 140176 St. Louis Built, 141174 Newark Built.

CODE	MODEL	CU. IN. ENG.	TRANSMISSION	LENGTH	DIA.	U-JOINTS	PART NO.
16-02-1	SHAFT						
	V1 All, L1 Sta. Wgn.	170, 225	3, 4 Speed and Auto.	53 13/32"	3"	With	*2530 895
	V2 All, L2 Sta. Wgn.	273	3, 4 Speed and Auto.	53 13/32"	3"	With	*2530 895
	L1, except Sta. Wgn.	170, 225	3, 4 Speed and Auto.	58 13/32"	3"	With	*2405 879
	L2, except Sta. Wgn.	273	3, 4 Speed and Auto.	58 13/32"	3"	With	*2405 879
	L1, L2, except Sta. Wgn.	170, 225, 273	Auto.	58 13/32"	2 3/4"	With	*2405 880
	P1, All, D1, Sta. Wgn. Police and Taxi	225	Auto.	53 7/8"	2 3/4"	With	*2405 628
	P1 All, D1 Sta. Wgn.	225	Auto.	53 7/8"	2 3/4"	With	*2405 625
	P2 All, D2 Sta. Wgn.	318, 361 383, 426	Auto.	53 7/8"	2 3/4"	With	*2405 628
	P2, All, D2 Sta. Wgn.	225	Auto.	53 7/8"	2 3/4"	With	*2405 628
P1 All, D1 Sta. Wgn.	225	3 Speed	56"	3"	With	*2405 631	
P2 All, D2 Sta. Wgn.	225, 361, 383	3 Speed	56"	3"	With	*2405 634	
P2 All, D2 Sta. Wgn.	361, 383	4 Speed	53 7/8"	3"	With	*2405 640	
P2 All, D2 Sta. Wgn.	426	4 Speed and Auto.	53 7/8"	3"	With	*2405 640	
P2 All, D2 Sta. Wgn., Police Cars	318, 361, 383	Auto.	53 7/8"	3"	With	*2405 643	
P2, Maximum Performance	426	4 Speed and Auto.	53 1/8"	3"	With	*2460 504	
D2, Maximum Performance	426	4 Speed and Auto.	56 1/8"	3"	With	*2460 510	
D1, except Sta. Wgn.	225, 318	3 Speed	59"	2 3/4"	With	*2405 644	
D1, except Sta. Wgn.	225	Auto.	59"	3"	With	*2405 650	
D2, except Sta. Wgn.	318, 383, 361	3 Speed	59"	3"	With	*2405 650	
D2, except Sta. Wgn.	383	4 Speed	56 7/8"	2 3/4"	With	*2405 662	

* Indicates use as required.

Numerals in parentheses () refer to notes.

Printed in U.S.A.

⊠ Indicates parts not listed in any previous parts book.

Prices and specifications subject to change without notice.

* Indicates change or addition.

16-02-0 PROPELLER SHAFT - Cont'd

CODE	MODEL	CU. IN. ENG.	TRANSMISSION	LENGTH	DIA.	U-JOINTS	PART NO.
16-02-1	SHAFT - Cont'd						
	D2, except Sta. Wgn.	426	4 Speed and Auto.	56 7/8"	2 3/4"	With	*2405 662
	D2, except Sta. Wgn.	318, 361, 383	Auto.	56 7/8"	2 3/4"	With	*2405 662
	D2, except Sta. Wgn.	318, 361, 383	Auto.	56 7/8"	2 3/4"	With	*2405 653
	D1, D2, except Sta. Wgn. Police Cars	225	Auto.	56 7/8"	2 3/4"	With	*2405 653
	P2 All, V2 Sta. Wgn. Maximum Performance	426	3 Speed	53 1/2"	3"	With	E2460 501
	D2 Sta. Wgn. Maximum Performance	426	3 Speed	56 1/2"	3"	With	E2460 507
	V1 All, L1 Sta. Wgn.	170, 225	3, 4 Speed and Auto.	53 13/32"	3"	w/Out	*2206 974
	L1, except Sta. Wgn.	170, 225	3 Speed and Auto.	58 13/32"	3"	w/Out	*2401 462
	V2 All, L2 Sta. Wgn.	273	3 Speed and Auto.	53 13/32"	3"	w/Out	*2206 974
	L2, except Sta. Wgn.	273	Auto.	58 13/32"	3"	w/Out	*2401 462
	L1, L2, except Sta. Wgn.	170, 225, 273	Auto.	58 13/32"	3 1/4"	w/Out	*2405 881
	P1 All, D1 Sta. Wgn.	225, 318	3 Speed	56"	3"	w/Out	*2405 632
	P2 All, D2 Sta. Wgn.	426	4 Speed and Auto.	53 7/8"	3"	w/Out	*2405 841
	D2, except Sta. Wgn. Police and Taxi	225	3 Speed Heavy Duty	58 7/8"	2 3/4"	w/Out	E2405 654
	D2, except Sta. Wgn.	318, 383, 426	Auto.	56 7/8"	2 3/4"	w/Out	E2405 654
	D1, except Sta. Wgn.	225	Auto.	56 7/8"	3"	w/Out	*2530 850
	A3, C1, C2	413	4 Speed and Auto.	58 7/8"	2 3/4"	w/Out	*2401 476
	A3, C1, C2, C3	361, 383, 413	Auto.	58 7/8"	2 3/4"	w/Out	*2401 476
	Y1, Front	413	Auto.	25 13/16"	2 3/4"	w/Out	*2200 527
	Y1, Rear	413	Auto.	33 5/8"	2 3/4"	w/Out	*1946 297
	A3, C1	361	Auto.	58 3/4"	3 1/4"	With	*2460 925
	A3, C2	383	Auto.	58 3/4"	3 1/4"	With	*2460 925
	C3	413	Auto.	58 3/4"	3 1/4"	With	*2460 925
	C1	361	3 Speed	58 3/4"	3"	With	*2401 478
	A3, C1, C2	413	3 Speed and Auto.	58 3/4"	3"	With	*2401 478
	A3, Police Cars	361, 383	3 Speed and Auto.	58 3/4"	3"	With	*2401 478
	A3, C2	383	4 Speed	58 3/4"	3 1/4"	With	*2460 925
	Y1, Constant Velocity	413	Auto.	-----	-----	With	*2533 201

★ Indicates use as required.

Numerals in parentheses () refer to notes.

Printed in U.S.A.

⊠ Indicates parts not listed in any previous parts book.

Prices and specifications subject to change without notice.

March 15, 1965 Supersedes March 16, 1964.

Page 16-4

* Indicates change or addition.

CODE	PART NAME AND DESCRIPTION	CYL	PER CAR	VALIANT DART	PLYMOUTH DODGE	CHRYSLER IMPERIAL
16-02-0 PROPELLER SHAFT - Cont'd						
16-02-5	BOLT, Auto. Trans.		4	*2466 208		
	BOLT, Trans. End, Std. Trans.		4	*1942 069	*1942 069	*1942 069
	SCREW, Axle End		4	2460 883	2460 883	2460 883
16-03-0 UNIVERSAL JOINT						
16-03-1	JOINT PACKAGE, Ball and Pin Type		1	2298 940		
		6	1	-----	2298 940	
	VP1, VD1, w/Auto. Trans.	6	1	-----	*2298 941	
	VP1, VD1, w/Auto Trans., Police and Taxi, UP TO Note 3	6	★	-----	*2298 940	
	AFTER Note 3	6	1	-----	*2298 941	
		8	1	-----	2298 941	2298 941
	JOINT PACKAGE, Cross and Roller Type		1	1752 624	1752 624	1752 624
	CROSS and NEEDLE BEARING KIT, Constant Velocity Type, VY1		★	-----	-----	*2533 202
16-03-3	ROLLER PACKAGE		★	638 637	638 637	638 637
16-03-7	PIN, Universal Joint		1	579 445		
		6	1	-----	579 445	
		8	1	-----	1739 923	1739 923
16-03-10	BALL, w/ROLLER		2	1739 927	1739 927	1739 927
16-03-16	WASHER, Thrust		2	605 004	605 004	605 004
16-03-19	COVER, Universal Grease.		1	602 820		
		6	1	-----	2266 923	
		8	1	-----	2266 922	2266 922
16-03-20	GASKET, Universal Joint		1	1616 185	1616 185	
		8	1	-----	1635 098	1635 098
16-04-0 UNIVERSAL JOINT BODY						
16-04-1	BODY		1	1734 159		
		6	1	-----	1734 159	
	VP1, VD1, w/Auto. Trans., Police and Taxi, UP TO Note 3	6	1	-----	*1734 159	
	AFTER Note 3	6	1	-----	*1739 920	
		8	1	-----	1739 920	1739 920
16-06-0 UNIVERSAL JOINT CENTERING BUTTON						
16-06-1	BUTTON	6	2	629 768	629 768	
		6	2	-----	629 768	
		8	2	-----	1739 924	1739 924
16-06-3	SPRING, Centering Button		2	1739 926	1739 926	1739 926
16-07-0 UNIVERSAL JOINT COVER						
16-07-3	CLAMP, 1 5/8 in. dia.		★	870 540	870 540	870 540
	2 1/2 in. dia.		★	870 539	870 539	870 539
	2 13/16 in. dia.		★	1532 943	1532 943	1532 943
16-07-4	COVER PACKAGE, Dust		1	1603 397	1603 397	
		6	1	-----	1603 397	
		8	1	-----	1450 448	1450 448

★ Indicates use as required.

Numerals in parentheses () refer to notes.

Printed in U.S.A.

☐ Indicates parts not listed in any previous parts book.

Prices and specifications subject to change without notice.

* Indicates change or addition.

1964 PASSENGER CAR PARTS CATALOG

PROPELLER SHAFT
AND UNIV. JOINT

CODE	PART NAME AND DESCRIPTION	CYL	PER CAR	VALIANT DART	PLYMOUTH DODGE	CHRYSLER IMPERIAL
16-08-0 UNIVERSAL JOINT CROSS						
16-08-6	SEAL, Dust		4	857 999	857 999	857 999
16-08-7	RETAINER, Dust Seal		4	1739 912	1739 912	1739 912
16-10-0 UNIVERSAL JOINT CROSS ROLLER AND BUSHING						
16-10-1	ROLLER, w/BUSHING		4	1739 913	1739 913	1739 913
16-10-2	RETAINER, Bushing		4	858 006	858 006	858 006
16-10-3	CLAMP, Bushing		2	1828 824	1828 824	1828 824
	VY1	8	2	----	----	*2533 181
16-14-0 PROPELLER SHAFT SPLINE OR SLIDING YOKE						
16-14-1	YOKE, VY1	8	1	----	----	1739 915
	VALVE, Yoke Pressure, VY1	8	1	----	----	106 671
16-14-7	SEAL, Yoke, VY1	8	1	----	----	1872 049
	SEAL, Spline Oil, Constant Velocity, VY1	8	1	----	----	*2533 208
16-14-8	RETAINER, Spline Oil Seal, Constant Velocity Type, Y1	8	1	----	----	*2533 209
16-14-9	CAP, Yoke Oil Seal, VY1	8	1	----	----	1672 050
16-16-0 PROPELLER SHAFT CENTER BEARING						
16-16-1	BEARING, VY1	8	1	----	----	1672 051
	BEARING, Constant Velocity Type, Y1	8	1	----	----	*2533 204
16-16-4	NUT, Centering Bearing Shaft, Constant Velocity Type, Y1	8	1	----	----	*2533 207
16-16-6	WASHER, Center Bearing	8	1	----	----	1638 151
	WASHER, Centering Bearing, Constant Velocity Type, Y1	8	1	----	----	*2533 206
16-16-7	CENTERING REPLACEMENT KIT, Constant Velocity Type, Y1	8	1	----	----	*2533 203
16-16-25	SNAP RING, Output Shaft Bearing, Outer, Thick		★	631 810	631 810	
	Thin		★	640 280	640 280	
	Med.		★	631 809	631 809	
16-16-43	SLINGER, Center Bearing VY1	8	2	----	----	1872 053
	SLINGER, Center Bearing Dust, Constant Velocity Type, Y1	8	1	----	----	*2533 205
16-16-47	SPACER, Center Bearing Insulator, except Cv. Cp.	8	★	----	----	1945 836
	Cv. Cp.	8	★	----	----	1856 944
16-17-0 PROPELLER SHAFT CENTER BEARING INSULATOR						
16-17-1	INSULATOR, VY1, except Cv. Cp.	8	1	----	----	1945 831
	VY1, Cv. Cp.	8	1	----	----	1856 942
	BOLT	8	2	----	----	181 643

★ Indicates use as required.

⊠ Indicates parts not listed in any previous parts book.

Ⓜ March 15, 1965 Supersedes March 16, 1964.

Numerals in parentheses () refer to notes.

Prices and specifications subject to change without notice.

* Indicates change or addition.

CODE	PART NAME AND DESCRIPTION	CYL	PER CAR	VALIANT DART	PLYMOUTH DODGE	CHRYSLER IMPERIAL
16-17-0 PROPELLER SHAFT CENTER BEARING INSULATOR - Cont'd						
16-17-1	INSULATOR - Cont'd.					
	WASHER, Lock	8	2	----	----	138 489
	WASHER, Plain	8	2	----	----	120 394
	NUT	8	2	----	----	120 369
16-20-0 PROPELLER SHAFT FLANGE						
16-20-1	FLANGE, Trans. Output, VV1, VL1, w/170, 225 cu. in. Eng. w/3 Speed Manual Trans.	6	1	2400 974		
	VV2, VL2, w/273 cu. in. Eng. 3 Speed Manual Trans.	8	1	2400 977		
	VV1, VL1, VV2, VL2, w/225, 273 cu. in. Eng. 4 Speed Manual Trans.		1	2400 977		
	VV1, VL1, w/170, 225 cu. in. Eng. Auto. Trans.	6	1	2400 974		
	VV2, VL2, w/273 cu. in. Eng., Auto. Trans.	8	1	2464 438		
	VP1, VD1, w/225 cu. in. Eng., 3 Speed Manual Trans.	6	1	----	2400 976	
	VP1, VD1, w/225 cu. in. Eng., 3 Speed Heavy Duty Manual Trans., Police and Taxi UP TO Note 3	6	1	----	*2400 977	
	VP2, VD2, w/318, 426, 361, 383, cu. in. Eng. w/3 Speed Manual Trans.	8	1	----	2400 978	
	VP2, VD2, w/318, 426, 361, 383, cu. in. Eng., 4 Speed Manual Trans.	8	1	----	2400 978	
	VA3, VC1, VC2, w/361, 383 cu. in. Eng. 3 and 4 Speed Manual Trans.	8	1	----	2400 978	2400 978
	VV1, VL1, w/170, 225 cu. in. Eng. Auto. Trans.	6	1	2400 974		
	VP1, VD1, w/225 cu. in. Eng. Auto. Trans.	6	1	----	2400 975	
	VP1, VD1, w/225 cu. in. Eng. Auto. Trans., Police and Taxi AFTER Note 3	6	1	----	*2400 978	
	VV2, VL2, w/273 cu. in. Eng. Auto. Trans.	8	1	2464 438		
	VP2, VD2, w/318, 426, 361, 383, cu. in. Eng., Auto. Trans.	8	1	----	2400 978	
	VA3, VC1, VC2, VC3, w/361, 383, 413, cu. in. Eng., Auto. Trans.	8	1	----	----	2400 978
	VY1, w/413 cu. in. Eng., Auto. Trans. w/10 Splines	8	1	----	*2404 479	*2400 979
	FLANGE PACKAGE, Axle Drive Pinion		1	2240 614	2240 612	2240 612
	YOKE, Drive Pinion Sure Grip, VY1	8	1	----	----	*2467 256
	YOKE, Trans. Output, Constant Velocity Type, w/23 Splines, Y1	8	1	----	----	*2405 674
	ADAPTER, Trans. Flange VY1	8	1	----	----	*2200 214
16-20-2	WASHER, Drive Pinion Flange 15/16" L.D., 1 9/16" O.D.		1	*2070 117	*2070 117	*2070 117
	WASHER, Drive Pinion Flange 5/8" L.D., 1 9/16" O.D.		1	*1556 556	*1556 556	*1556 556
16-20-3	NUT, Drive Pinion Flange, 7/8 - 14 thd.		1	2070 118	*1556 638	*1556 638
16-20-8	NUT and WASHER PACKAGE, Trans. Flange		1	2298 967	2298 967	2298 967

NOTES

* Indicates use as required. Numerals in parentheses () refer to notes. Printed in U.S.A.
 E Indicates parts not listed in any previous parts book. Prices and specifications subject to change without notice.
 * Indicates change or addition. March 15, 1965.

