

GROUP 5 - BRAKE-SERVICE

288167C

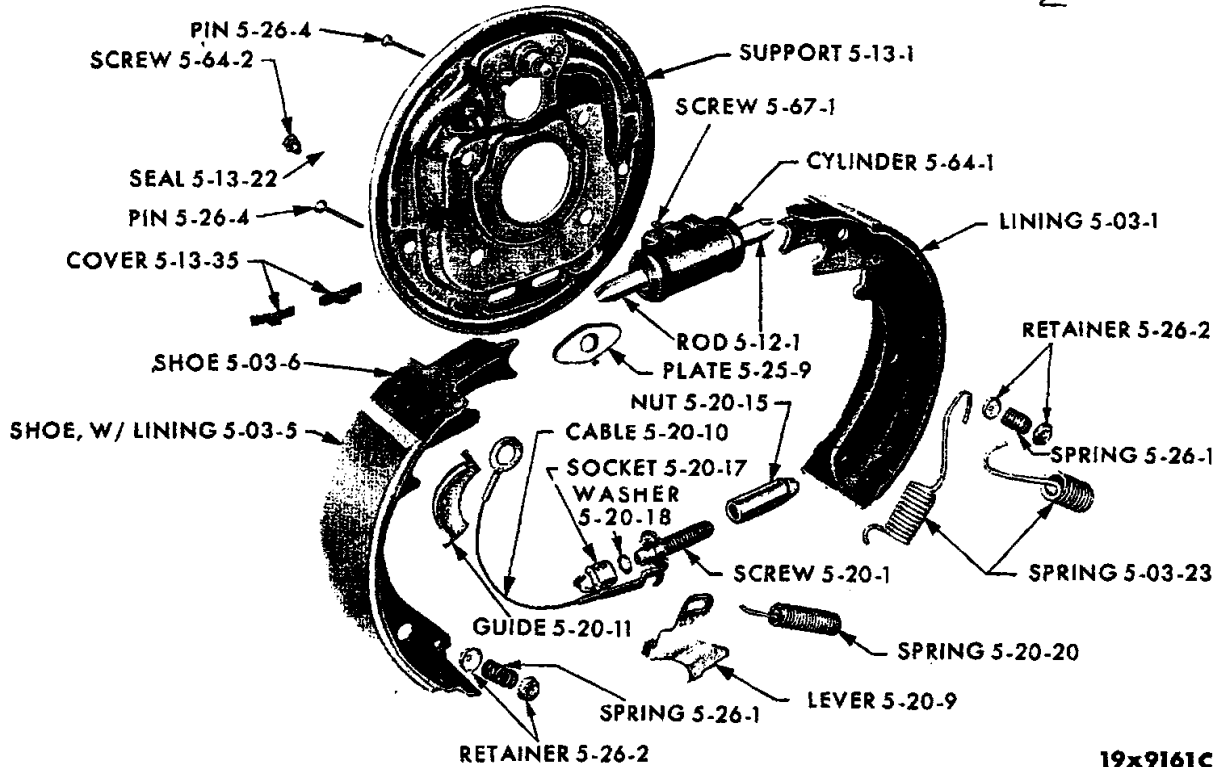

19x9161C

FRONT WHEEL BRAKE - PLYMOUTH VP1-2 AND DODGE VD1-2

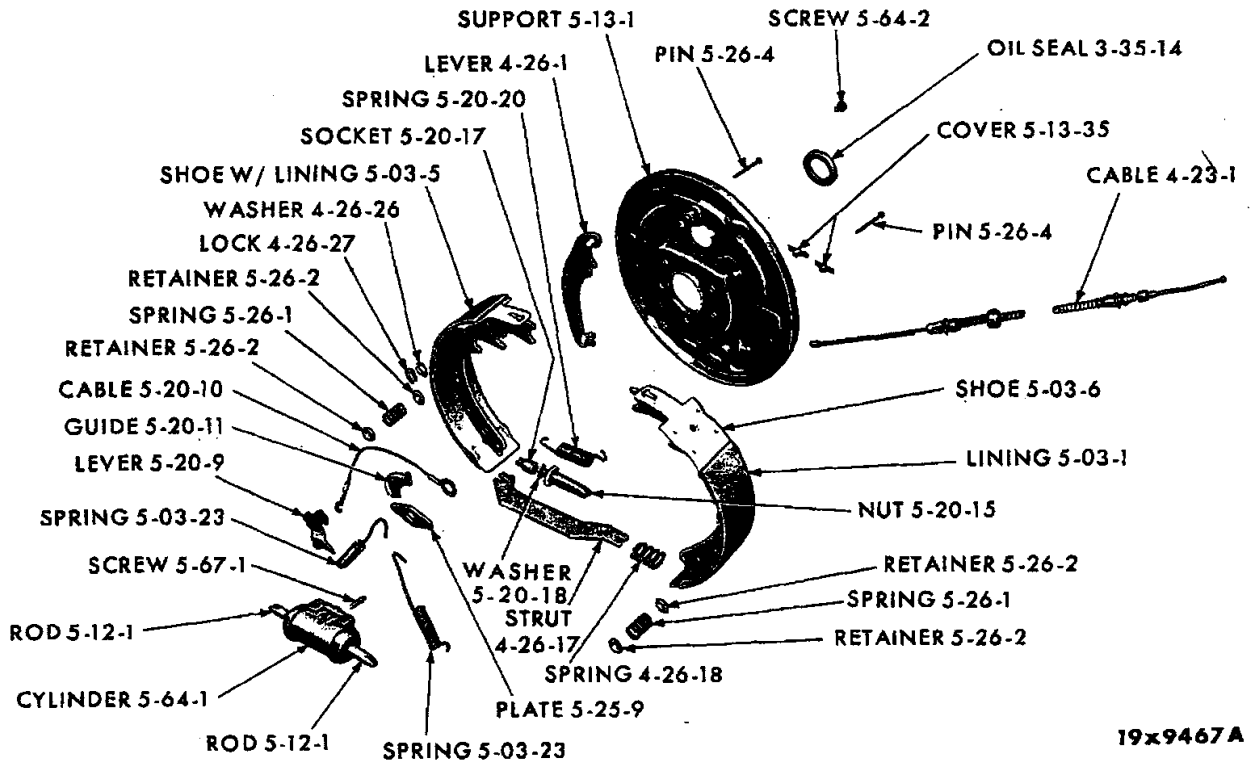

19x9467A

REAR WHEEL BRAKE - PLYMOUTH VP1-2, DODGE VD1-2, CHRYSLER VC1-2-3 AND IMPERIAL VY1



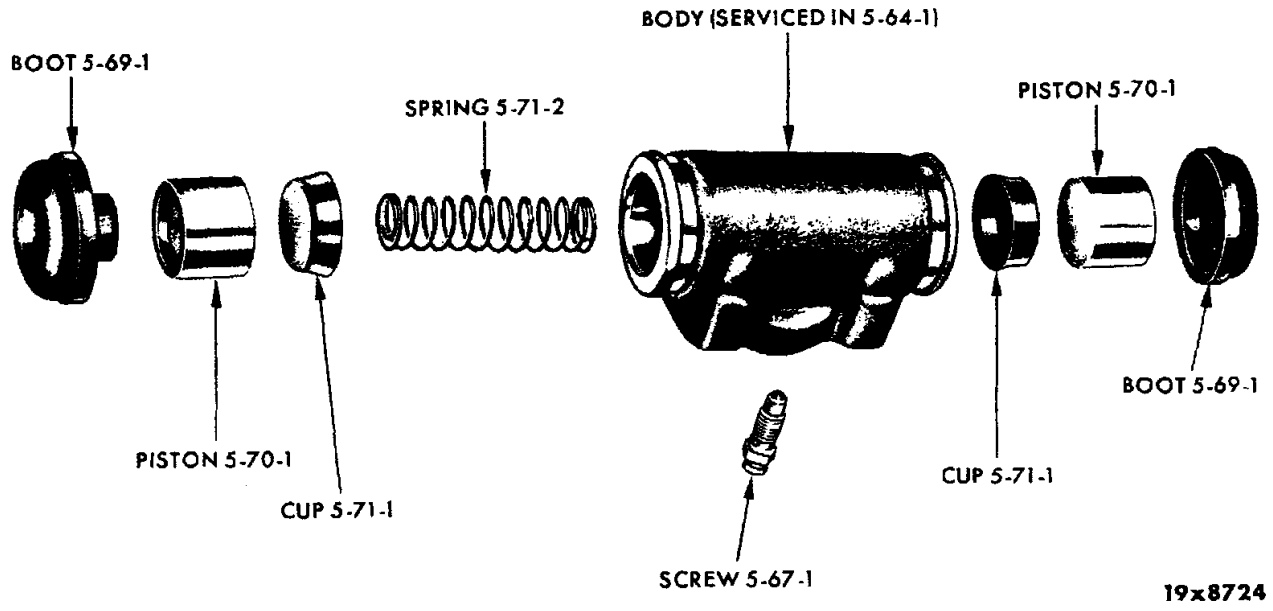

WHEEL CYLINDER

PARTS INDICATED BY NAME ONLY - ORDER BY DESCRIPTION

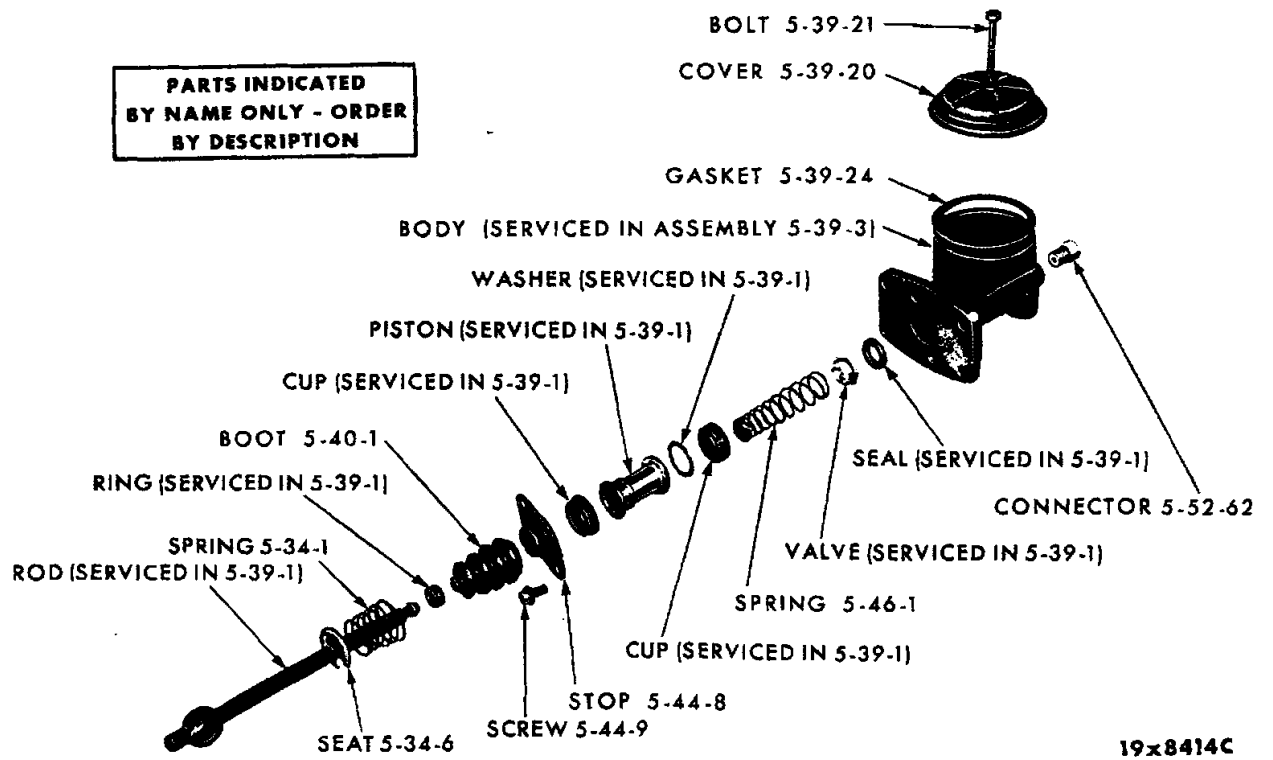

MASTER CYLINDER - WITHOUT POWER BRAKES

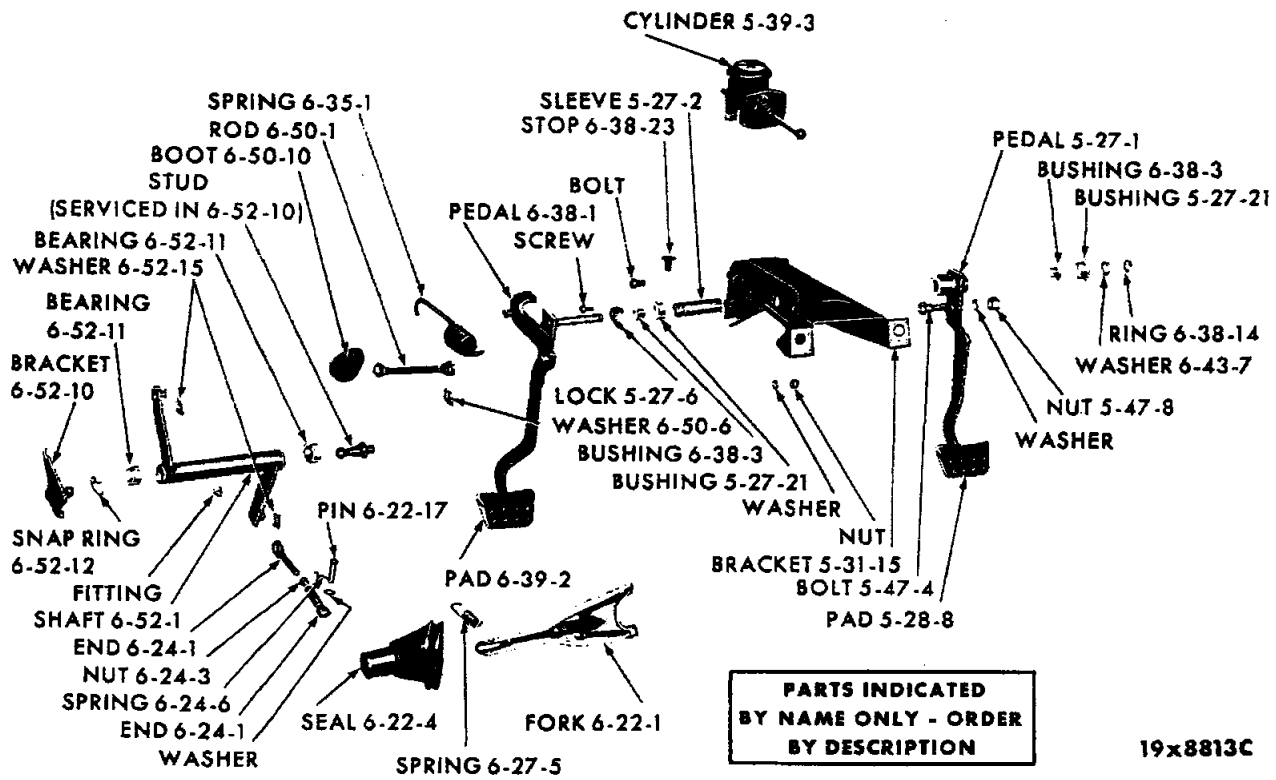

BRAKE AND CLUTCH PEDAL LINKAGE - VALIANT VV1-2 AND DART VL1-2 (WITH MANUAL TRANSMISSION)

**NOTES**

Series of horizontal lines provided for additional notes or specifications.

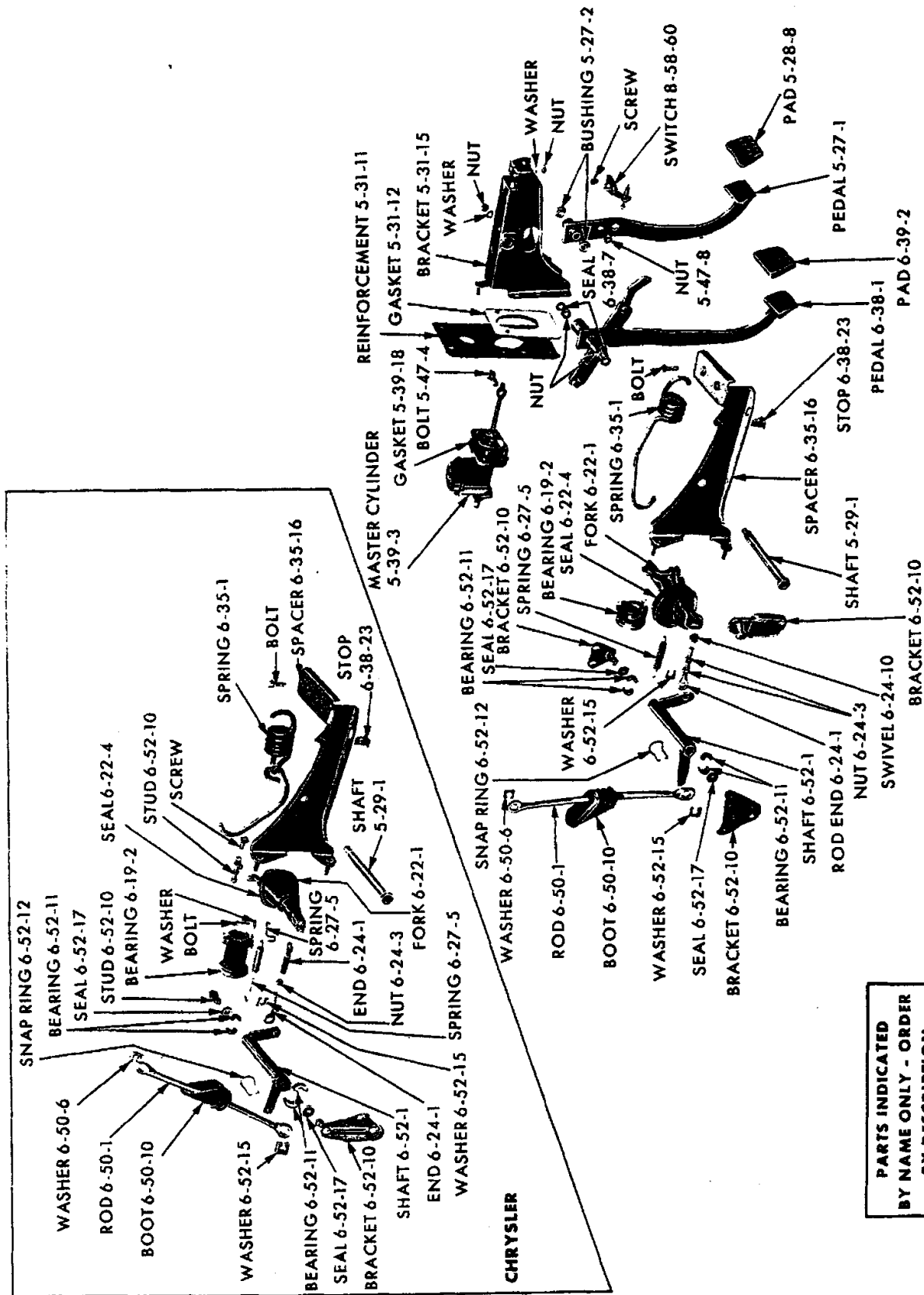

PARTS INDICATED  
BY NAME ONLY - ORDER  
BY DESCRIPTION

19 x 9314B

BRAKE AND CLUTCH PEDAL LINKAGE - PLYMOUTH VP1-2, DODGE VDI-2 AND CHRYSLER VCI-2-3 (WITH MANUAL TRANSMISSION)

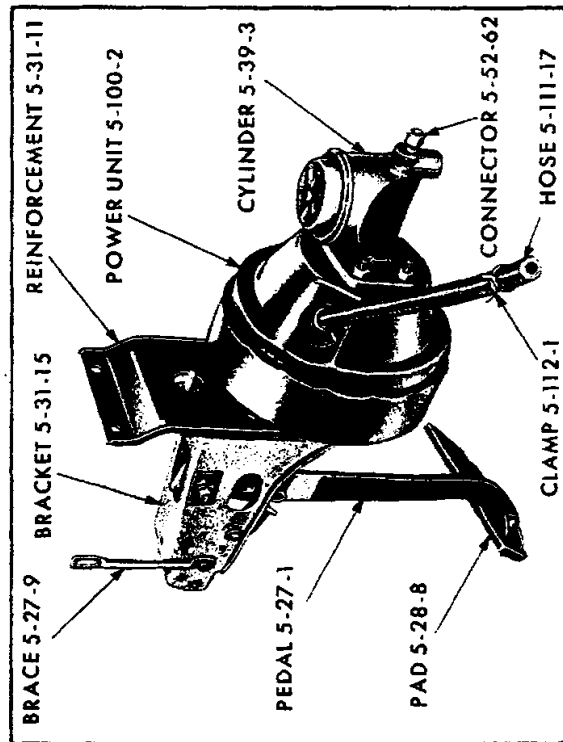
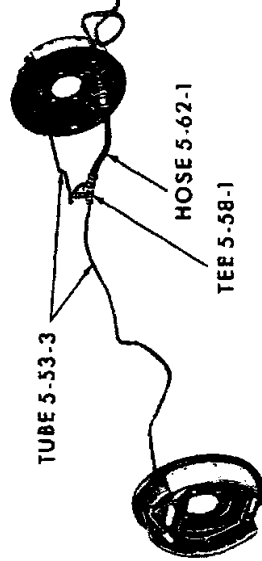
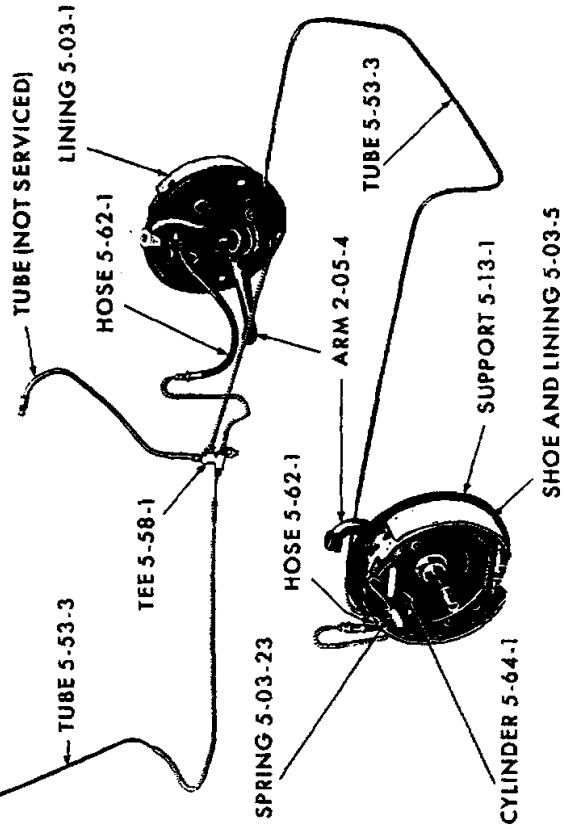
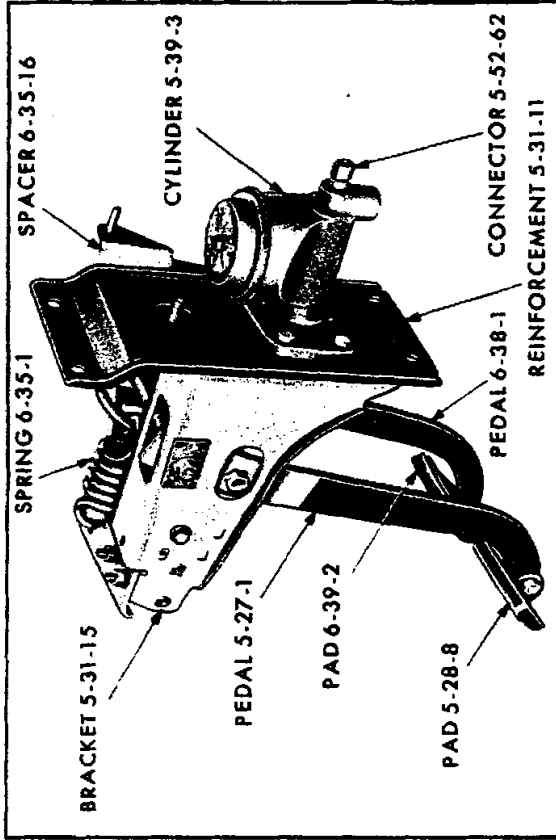

19x9352A

HYDRAULIC BRAKE SYSTEM

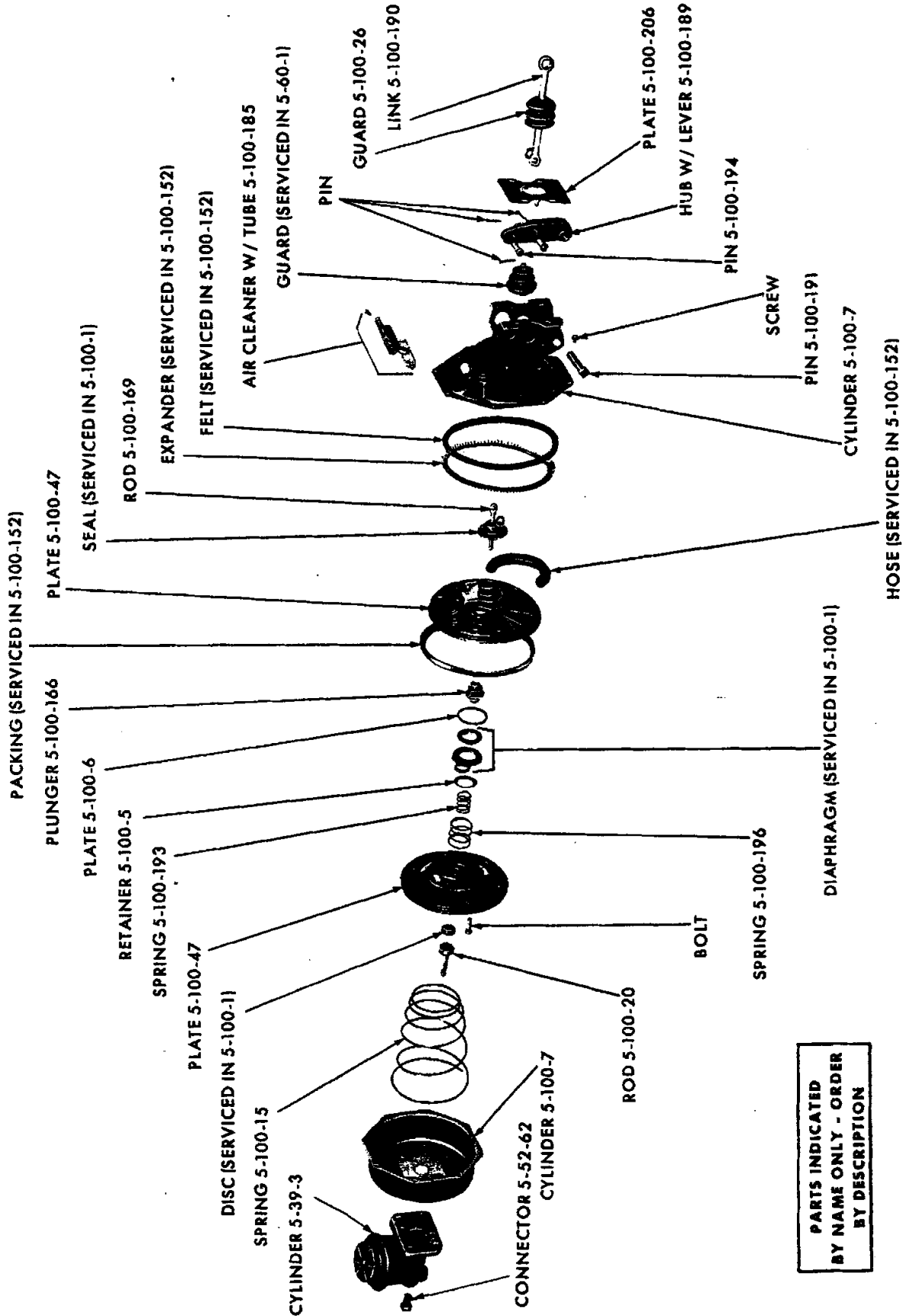

PARTS INDICATED  
BY NAME ONLY - ORDER  
BY DESCRIPTION

19x8754A

POWER BRAKE POWER UNIT - VALIANT VV1-2 AND DART VL1-2 (BENDIX TYPE)

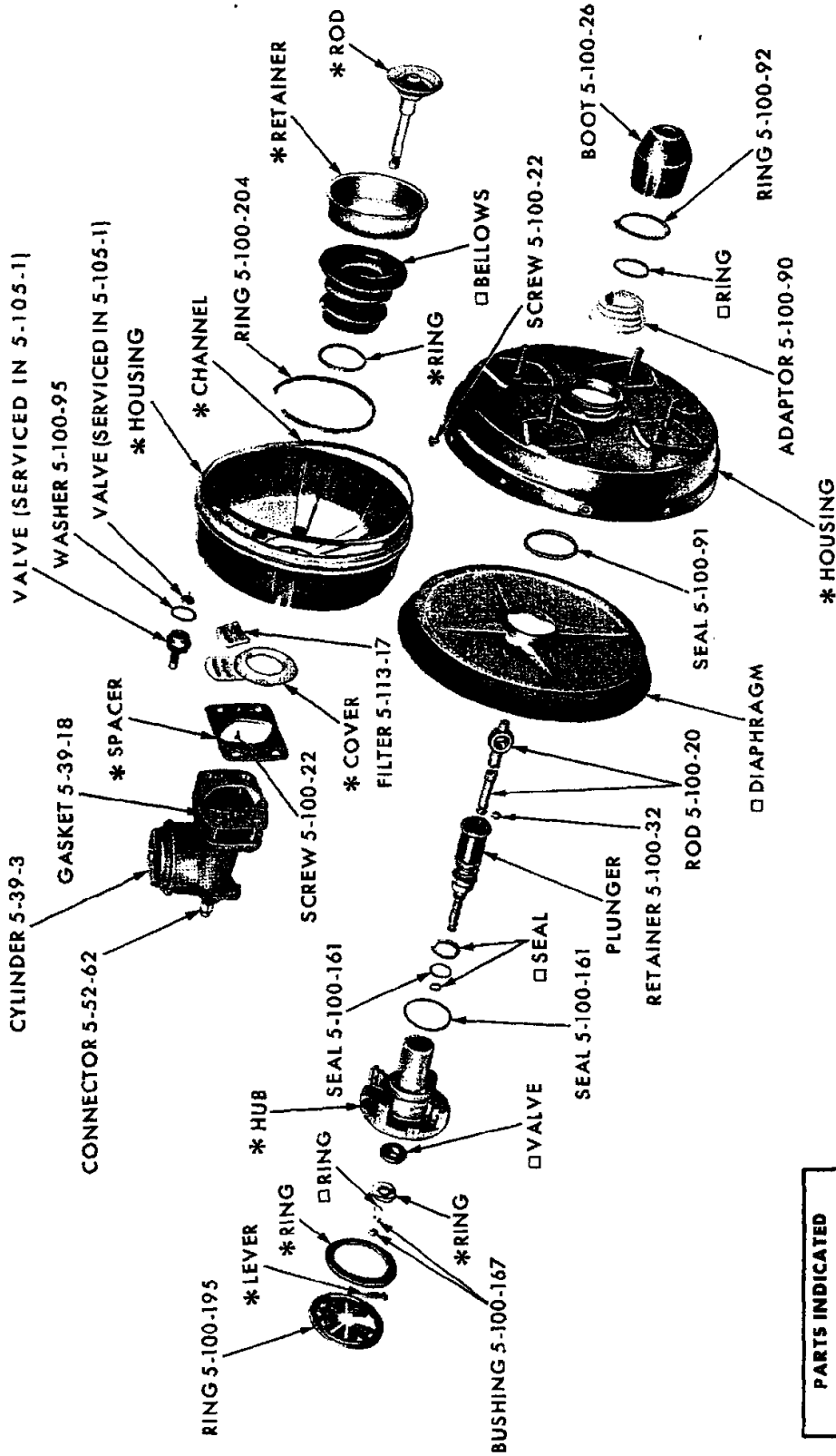

19x9380B

PARTS INDICATED  
BY NAME ONLY - ORDER  
BY DESCRIPTION

□ SERVICED IN 5-100-1  
\* SERVICED IN 5-100-2

POWER BRAKE POWER UNIT - PLYMOUTH VP1-2, DODGE VD1-2, VA3 AND CHRYSLER VC1-2-3 (MIDLAND-ROSS TYPE)



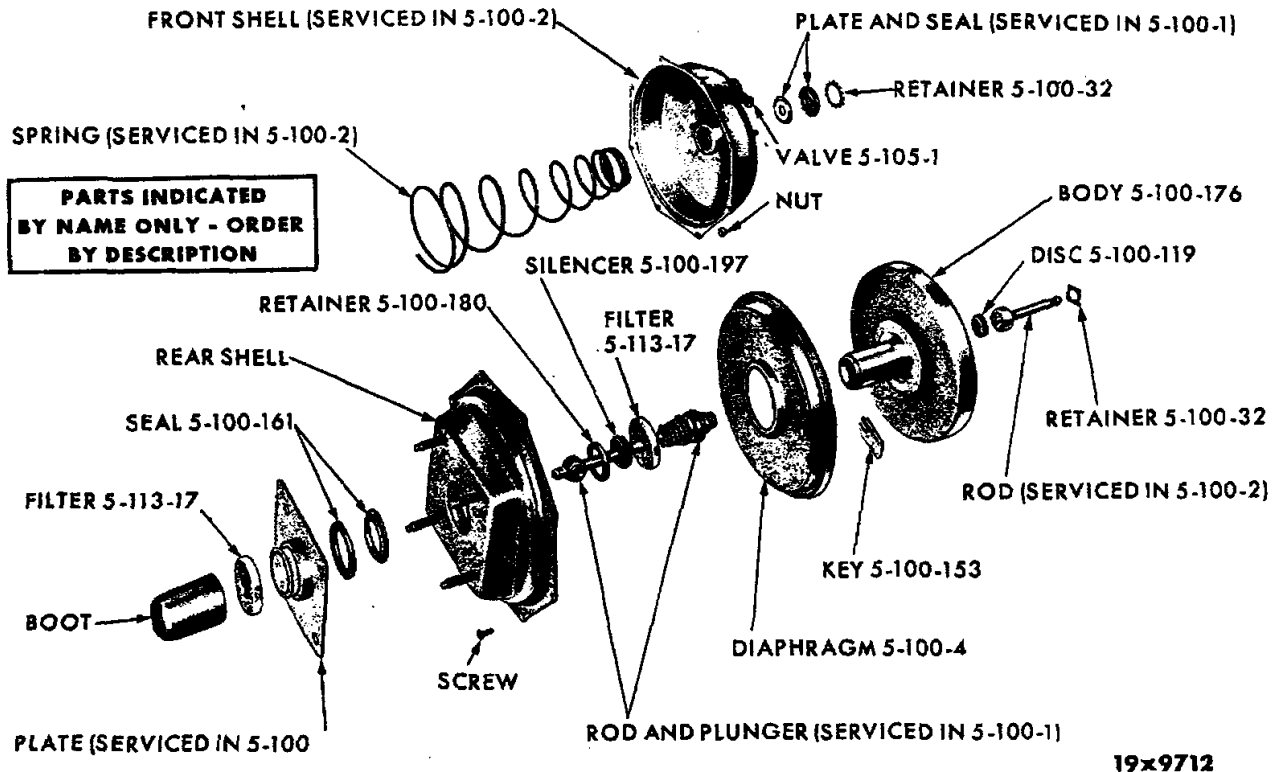

POWER BRAKE POWER UNIT - PLYMOUTH VP1-2, DODGE VD1-2, VA3, CHRYSLER VC1-2 EXCEPT VC2-300K (BENDIX TYPE)

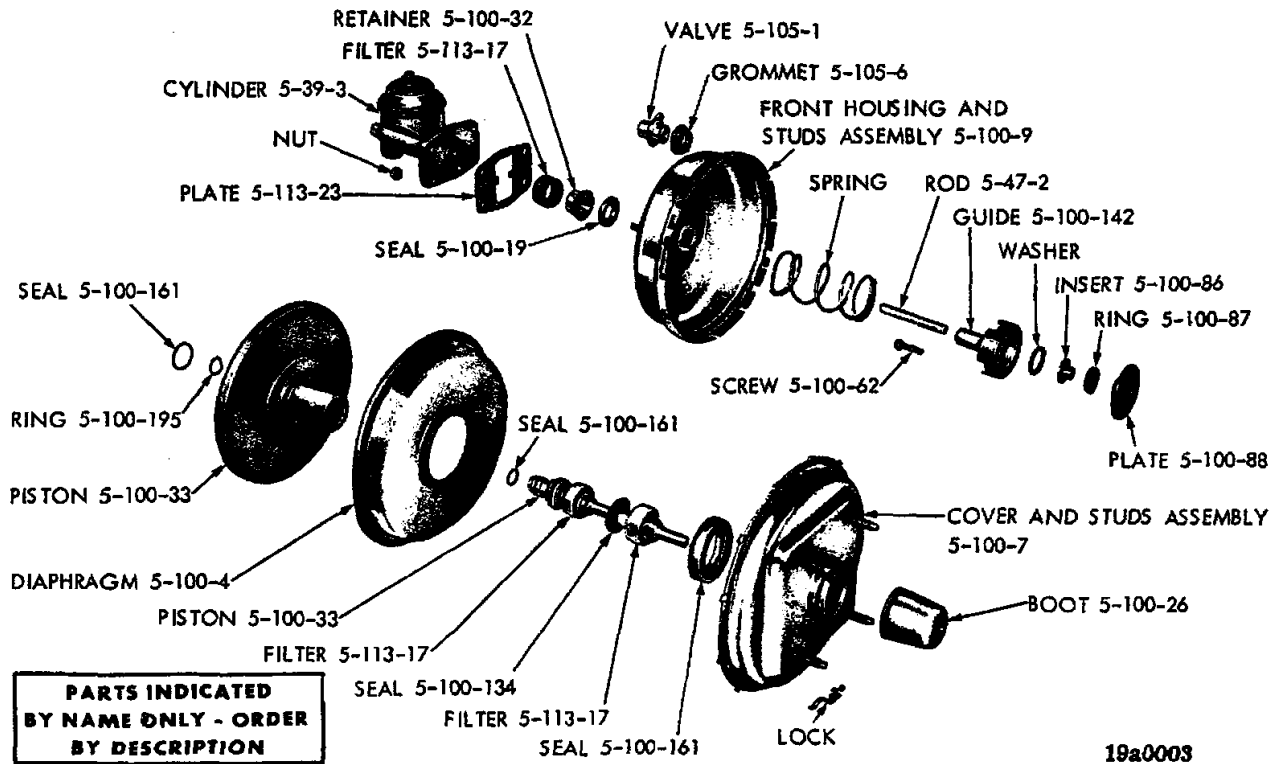

POWER BRAKE POWER UNIT - PLYMOUTH VP1-2 AND DODGE VD1-2 (KELSEY-HAYES TYPE)

19x9728

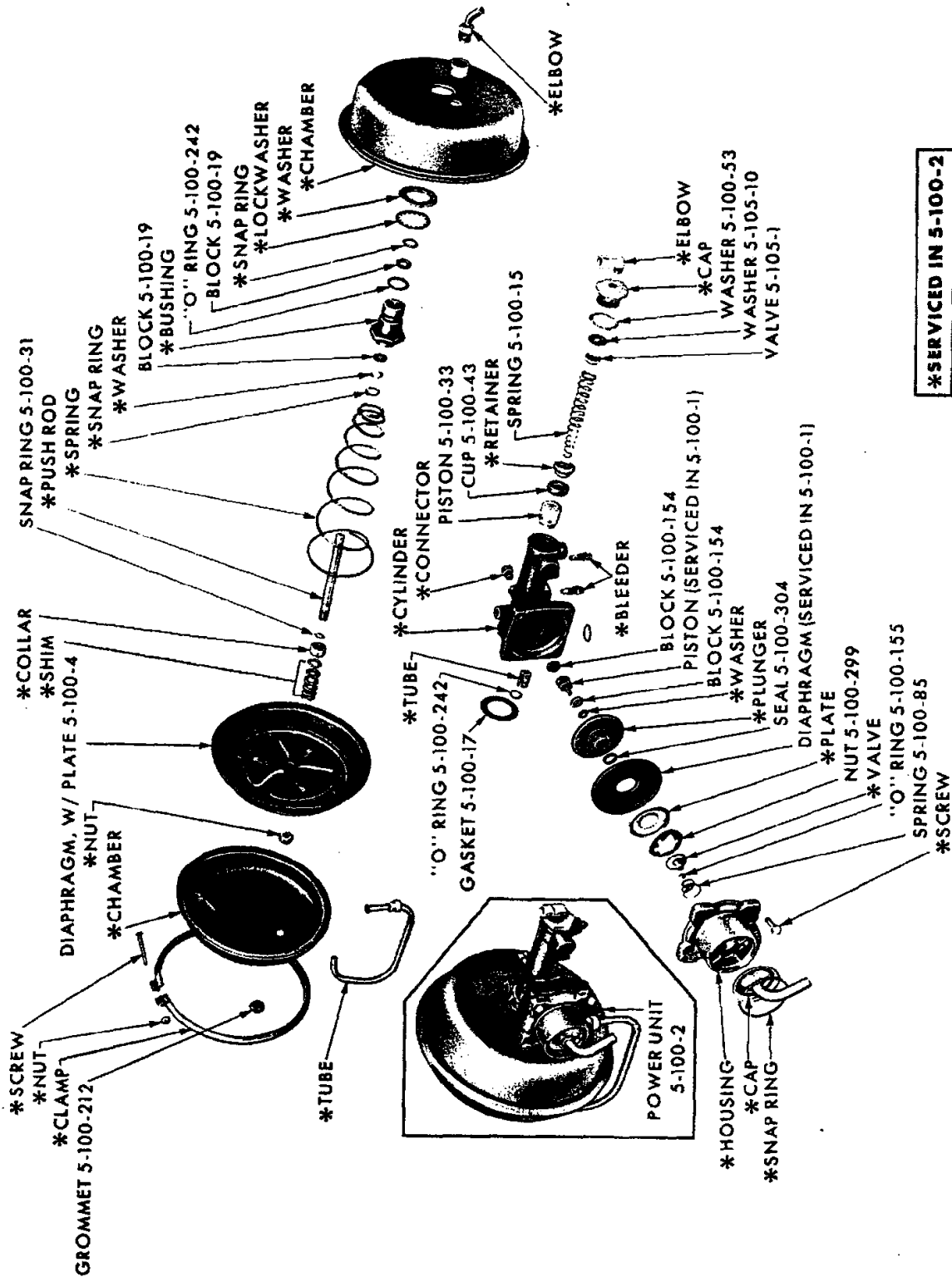

\*SERVICED IN 5-100-2

POWER BRAKE POWER UNIT - CHRYSLER VC3-300K (MIDLAND-ROSS TYPE)

CODE	PART NAME AND DESCRIPTION	C Y L	PER CAR	VALIANT DART	PLYMOUTH DODGE	CHRYSLER IMPERIAL
<b>5-01-0 BRAKE FLUID</b>						
5-01-1	FLUID, 12 oz. Can . . . . .		★	2421 352	2421 352	2421 352
	1 Quart Can . . . . .		★	1879 270	1879 270	1879 270
	1 Gallon Can . . . . .		★	1879 271	1879 271	1879 271
	5 Gallon Can . . . . .		★	1879 272	1879 272	1879 272
	30 Gallon Drum . . . . .		★	1879 273	1879 273	1879 273
<b>5-03-0 WHEEL BRAKE SHOE AND LINING</b>						
5-03-1	LINING PACKAGE, except Taxi, 9" Brakes . . . . .		1	2448 321		
	Taxi Only, 9" Brakes . . . . .		1	2298 943		
	Standard, 10" Brakes . . . . .		1	----	2298 842	
	Taxi, 11" Brakes . . . . .		1	----	2421 314	
	Police and Heavy Duty, 11" Brakes . . . . .		1	----	2298 848	
	11" x 3" Front, 11" x 2 1/2" Rear Brakes, VA3, VC1, VC2, VC3 except Sta. Wgn. . . . .	8	1	----	2495 005	2495 005
	11" x 3" Front, 11" x 3" Rear Brakes, VC3 Sta. Wgn. . . . .	8	1	----	2495 006	2495 006
	11" x 3" Front, 11" x 3" Rear Brakes, VA3, VC1, Police, VC3 w/Trailer . . . . .	8	1	----	2448 320	2448 320
5-03-3	SHOE and LINING PACKAGE, Front Wheel Brake, Axle Set, 9" Brake . . . . .		1	E2585 505		
	Rear Wheel, Axle Set, 9" Brake . . . . .		1	E2585 506		
	Front and Rear Wheel, Axle Set, 10" Brake, VP1, VP2, VD1, VD2 . . . . .		2	----	E2585 502	
	Front Wheel, Axle Set, 11" Brake, VP1, VP2, VD1, VD2, Police, Heavy Duty, Trailer Towing Package, VA3 . . . . .	1	---	----	E2585 510	E2585 510
	Rear Wheel, Axle Set, 11" Brake, VP1, VP2, VD1, VD2, Police, Heavy Duty, Trailer Towing Package, VA3, VC1, VC2, VC3 except Sta. Wgn. Front Wheel, Axle Set, 11" Brake, Taxi, VP1, VP2, VD1, VD2 . . . . .	1	----	----	E2585 511	E2585 511
	Rear Wheel, Axle Set, 11" Brake, Taxi, VP1, VP2, VD1, VD2 . . . . .	1	----	----	E2585 512	
	Rear Wheel, Axle Set, 11" Brake, Taxi, VP1, VP2, VD1, VD2 . . . . .	1	----	----	E2585 513	
	Rear Wheel, Axle Set, 11" Brake, VA3 Police, Trailer Towing Package, Power Pack, VC1 Police Trailer Towing Package, VC2 Heavy Duty Trailer Towing Package, VC3 Sta. Wgn., VC3 except Sta. Wgn. Trailer Towing Package VY1 . . . . .	8	1	----	E2585 510	E2585 510
	Front Wheel, Axle Set, 11" Brake, VA3 Police, Trailer Towing Package, Power Pack, VC1 Police Trailer Towing Package, VC2 Heavy Duty Trailer Towing Package, VC3 except Sta. Wgn. Trailer Towing Package . . . . .	8	1	----	E2585 511	E2585 511
5-03-5	SHOE, w/LINING, Front Wheel, Front Shoe . . . . .		2	2405 804		
	Front Wheel, Rear Shoe . . . . .		2	2405 807		
	Rear Wheel, Front Shoe . . . . .		2	2405 814		
	Rear Wheel, Rear Shoe . . . . .		2	2405 817		
	Front Wheel, Front Shoe, 11" Brakes, Taxi . . . . .		2	----	2401 806	
	Front Wheel, Rear Shoe, 11" Brakes, Taxi . . . . .		2	----	2401 807	
	Rear Wheel, Front Shoe, 11" Brakes, Taxi . . . . .		2	----	2401 800	
	Rear Wheel, Rear Shoe, 11" Brakes, Taxi . . . . .		2	----	2401 801	
	Front Wheel, Front Shoe, 11" Brakes, Police and Heavy Duty, VP1, VP2, VD1, VD2 . . . . .		2	----	*2401 011	
	Front Wheel, Rear Shoe, 11" Brakes, Police and Heavy Duty, VP1, VP2, VD1, VD2 . . . . .		2	----	*2401 012	
	Rear Wheel, Front Shoe, 11" Brakes, Police and Heavy Duty, VP1, VP2, VD1, VD2 . . . . .		2	----	*2401 007	

★ Indicates use as required.

Numerals in parentheses ( ) refer to notes.

Printed in U.S.A.

E Indicates parts not listed in any previous parts book.

Prices and specifications subject to change without notice.

\* Indicates change or addition.

# 1964 PASSENGER CAR PARTS CATALOG

BRAKE-SERVICE

CODE	PART NAME AND DESCRIPTION	CYL	PER CAR	VALIANT DART	PLYMOUTH DODGE	CHRYSLER IMPERIAL
<b>5-03-0 WHEEL BRAKE SHOE AND LINING - Cont'd</b>						
5-03-5	SHOE, w/LINING - Cont'd					
	Rear Wheel, Rear Shoe, 11" Brakes, Police and Heavy Duty, VP1, VP2, VD1, VD2 . . . . .		2	----	*2401 008	
	Front Wheel, Front Shoe, 11" x 3" Brakes, Police and Heavy Duty, VP1, VP2, VD1, VD2 . . . . .		2	----	E2405 179	
	Front Wheel, Rear Shoe, 11" x 3" Brakes Police and Heavy Duty, VP1, VP2, VD1, VD2 . . . . .		2	----	*2409 882	
	Rear Wheel, Front Shoe, 11" x 2 1/2" Brakes, Police and Heavy Duty, VP1, VP2, VD1, VD2 . . . . .		2	----	*2405 175	
	Rear Wheel, Rear Shoe, 11" x 2 1/2" Brakes, Police and Heavy Duty, VP1, VP2, VD1, VD2 . . . . .		2	----	*2409 883	
	Front Wheel, Front Shoe, 11" x 3" Brakes, VA3, VC1, VC2, VC3 . . . . .	8	2	----	2405 179	2405 179
	Front Wheel, Rear Shoe, 11" x 3" Brakes, VA3, VC1, VC2, VC3 . . . . .	8	2	----	2409 882	2409 882
	Rear Wheel, Front Shoe, 11" x 2 1/2" Brakes, VA3, VC1, VC2, VC3 except Sta. Wgn. . . . .	8	2	----	2405 175	2405 175
	Rear Wheel, Rear Shoe, 11" x 2 1/2" Brakes, VA3, VC1, VC2, VC3 except Sta. Wgn. . . . .	8	2	----	2409 883	2409 883
	Rear Wheel, Front Shoe, 11" x 3" Brakes, VA3, VC3, Sta. Wgn. . . . .	8	2	----	2405 179	2405 179
	Rear Wheel, Rear Shoe, 11" x 3" Brakes, VA3, VC3 Sta. Wgn. . . . .	8	2	----	2409 882	2409 882
	Front and Rear Wheel, Front Shoe, 11" x 3" Brakes, VY1 . . . . .	8	4	----	----	2405 179
	Front and Rear Wheel, Rear Shoe, 11" x 3" Brakes, VY1 . . . . .	8	4	----	----	2409 882
	Front and Rear Wheel, Front Shoe, 11" Brakes, VA3, VC1, Police . . . . .	8	4	----	2401 011	2401 011
	Front and Rear Wheel, Rear Shoe, 11" Brakes, VA3, VC1, Police . . . . .	8	4	----	2401 012	2401 012
	Front Wheel, Front Shoe, 11" x 3" Brakes, Police, VA3, VC1 . . . . .	8	2	----	*2405 179	*2405 179
	Front Wheel, Rear Shoe, 11" x 3" Brakes, Police, VA3, VC1 . . . . .	8	2	----	*2409 882	*2409 882
	Rear Wheel, Front Shoe, 11" x 2 1/2" Brakes, Police, VA3, VC1 . . . . .	8	2	----	*2405 175	*2405 175
	Rear Wheel, Rear Shoe, 11" x 2 1/2" Brakes, Police, VA3, VC1 . . . . .	8	2	----	*2409 883	*2409 883
5-03-6	SHOE, Front Wheel, 9" x 2 1/4" Brakes . . . . .		4	2072 664		
	Rear Wheel, 9" x 2 1/2" Brakes . . . . .		4	2072 670		
	Front Wheel, 10" x 2 1/2" Brakes . . . . .		4	----	2260 812	
	Rear Wheel, 10" x 2 1/2" Brakes . . . . .		4	----	2260 812	
	Front Wheel, 11" x 3" Brakes, Taxi, Police and Heavy Duty . . . . .		4	----	2260 654	
	Rear Wheel, 11" x 2 1/2" Brakes, Taxi, Police and Heavy Duty . . . . .		4	----	2260 886	
	Front Wheel, 11" x 3" Brakes, VA3, VC1, VC2, VC3 . . . . .	8	4	----	2260 654	2260 654
	Rear Wheel, 11" x 2 1/2" Brakes, VA3, VC1, VC2, VC3 except Sta. Wgn. . . . .	8	4	----	2260 886	2260 886
	Rear Wheel, 11" x 3" Brakes, VA3, VC1, Police, VC3 Sta. Wgn. . . . .	8	4	----	2260 654	2260 654
5-03-23	SPRING, Brake Shoe Return, Front and Rear Wheel, 9" Brakes . . . . .		8	2072 719		
	Front and Rear Wheel, Front Shoe, 10" Brakes, VP1, VP2, VD1, VD2 . . . . .		4	----	2267 044	
	Front and Rear Wheel, Rear Shoe, 10" Brakes, VP1, VP2, VD1, VD2 . . . . .		4	----	2260 835	
	Front and Rear Wheel, 11" Brakes . . . . .		8	----	2260 789	2260 789

★ Indicates use as required.

Numerals in parentheses ( ) refer to notes.

Printed in U.S.A.

⊠ Indicates parts not listed in any previous parts book.

Prices and specifications subject to change without notice.

March 15, 1965 Supersedes March 16, 1964.

\* Indicates change or addition.

CODE	PART NAME AND DESCRIPTION	CYL	PER CAR	VALIANT DART	PLYMOUTH DODGE	CHRYSLER IMPERIAL
<b>5-12-O WHEEL CYLINDER PISTON PUSH ROD</b>						
5-12-1	ROD . . . . .		8	----	2260 787	2260 787
<b>5-13-O WHEEL BRAKE SUPPORT</b>						
5-13-1	SUPPORT, Front Wheel, 9" Brakes . . . . .		2	2072 609		
	Rear Wheel, Right, 9" Brakes . . . . .		1	*2533 076		
	Rear Wheel, Left, 9" Brakes . . . . .		1	2401 941		
	Front Wheel, 10" Brakes . . . . .		2	----	2265 581	
	Rear Wheel, Right, 10" Brakes . . . . .		1	----	2265 584	
	Rear Wheel, Left, 10" Brakes . . . . .		1	----	2265 585	
	Front Wheel, 11" x 3" Brakes, Taxi, Police and Heavy Duty . . . . .		2	----	2265 563	
	Rear Wheel, Right, 11" x 2 1/2" Brakes, Taxi, Police and Heavy Duty . . . . .		1	----	2265 564	
	Rear Wheel, Left, 11" x 2 1/2" Brakes, Taxi, Police and Heavy Duty . . . . .		1	----	2265 565	
	Front Wheel, 11" x 3" Brakes, VA3, VC1, VC2, VC3 . . . . .	8	2	----	2401 420	2401 420
	VY1 . . . . .	8	2	----	----	2266 867
	Rear Wheel, Right, 11" x 2 1/2" Brakes, VA3, VC1, VC2, VC3 except Sta. Wgn. . . . .	8	1	----	2265 564	2265 564
	Rear Wheel, Left, 11" x 2 1/2" Brakes, VA3, VC1, VC2, VC3 except Sta. Wgn. . . . .	8	1	----	2265 565	2265 565
	Rear Wheel, Right, 11" x 3" Brakes, VA3 . . . . .	8	1	----	2266 892	2266 892
	Rear Wheel, Left, 11" x 3" Brakes, VA3 . . . . .	8	1	----	2266 893	2266 893
5-13-7	GASKET, Brake Support, Rear . . . . .		4	*2467 095	2070 933	2070 933
5-13-9	BOLT, Support Mounting, Front, Upper, VP1, VP2, VD1, VD2 . . . . .		4	2072 682	2207 604	
	Lower, VP1, VP2, VD1, VD2 . . . . .		4	2072 681	2207 606	
	Front, 7/16" - 20 x 1 9/16", VA3 . . . . .	8	4	----	2207 604	2207 604
	Front, 7/16" - 20 x 2 7/16", VA3 . . . . .	8	2	----	2401 501	2401 501
	Front, 7/16" - 20 x 2 7/8", VA3 . . . . .	8	2	----	2401 502	2401 502
	Rear . . . . .		★	2265 572	2265 572	2265 572
5-13-10	NUT, Brake Support Mounting, Front, Upper . . . . .		4	601 014	601 014	601 014
	Front, Lower, VP1, VP2, VD1, VD2 . . . . .		4	1825 351	128 027	
	Front, Lower, VA3 . . . . .	8	4	----	272 314	272 314
	Rear . . . . .		★	1927 232	120 369	120 369
5-13-22	SEAL, to Steering Knuckle . . . . .		2	2401 960	2266 890	2266 890
5-13-35	COVER, Adjusting Screw Hole . . . . .		8	2072 614	2072 614	2072 614
<b>5-20-O WHEEL BRAKE ADJUSTER</b>						
5-20-1	SCREW, Right, 9" and 10" Brakes . . . . .		2	2260 826	2460 654	
	Left, 9" and 10" Brakes . . . . .		2	2260 827	2460 655	
	Right, 11" Brakes, except Police . . . . .		2	----	2260 782	2260 782
	Left, 11" Brakes, except Police . . . . .		2	----	2260 783	2260 783
	Right and Left, 11" Brakes, Police . . . . .		4	----	2265 201	
5-20-4	SPRING, Lock, 11" Brakes, Police . . . . .		4	----	2265 203	
5-20-9	LEVER, Automatic Adjusting, Right, except Police . . . . .		2	2260 794	2260 794	2260 794
	Left, except Police . . . . .		2	2260 795	2260 795	2260 795
5-20-10	CABLE, Automatic Adjusting, 9" and 10" Brakes . . . . .		4	2266 273	2401 513	
	11" Brakes, except Police . . . . .		4	----	2266 270	2266 270
5-20-11	GUIDE, Cable, except Police . . . . .		4	2260 793	2260 793	2260 793

\* Indicates use as required.      Numerals in parentheses ( ) refer to notes.      Printed in U.S.A.  
 † Indicates parts not listed in any previous parts book.      Prices and specifications subject to change without notice.      March 15, 1965 Supersedes March 16, 1964.  
 \* Indicates change or addition.      Page 5-13

CODE	PART NAME AND DESCRIPTION	CYL	PER CAR	VALIANT DART	PLYMOUTH DODGE	CHRYSLER IMPERIAL
<b>5-20-0 WHEEL BRAKE ADJUSTER - Cont'd</b>						
5-20-15	NUT, Adjusting Screw Pivot, Right, 9" and 10" Brakes		2	2260 572	2260 572	
	Left, 9" and 10" Brakes		2	2260 573	2260 573	
	Right, 11" Brakes, except Police		2	----	2260 670	2260 670
	Left, 11" Brakes, except Police		2	----	2260 671	2260 671
	Right and Left, 11" Brakes, Police		4	----	2260 671	
5-20-17	SOCKET, Adjusting Screw, 9" and 10" Brakes		4	2260 824	2260 824	
	11" Brakes		4	----	2265 068	2265 068
5-20-18	WASHER, Adjusting Screw Socket End, except Police		4	2266 271	2266 271	2266 271
5-20-20	SPRING, Automatic Adjuster, 9" and 10" Brakes		4	2266 272	2401 514	
	11" Brakes, except Police		4	----	2265 069	2265 069
<b>5-25-0 BRAKE SHOE GUIDE</b>						
5-25-9	PLATE, 10" Brakes		4	----	2267 045	
	11" Brakes		4	----	2260 788	2260 788
<b>5-26-0 WHEEL BRAKE SHOE HOLD-DOWN SPRING</b>						
5-26-1	SPRING, Hold-Down		8	2207 520	2260 791	2260 791
5-26-2	SEAT, Hold-Down Spring		8	----	2401 957	2401 957
	RETAINER, Hold-Down Spring		8	----	2260 792	2260 792
5-26-4	PIN, Hold-Down Spring, Front Wheel, 10" x 2 1/2" Brakes		4	----	2260 548	
	Front Wheel, 11" x 3" Brakes		4	----	2260 549	2260 549
	Rear Wheel, 10" x 2 1/2" and 11" x 2 1/2" Brakes		4	----	2260 548	2260 548
	Rear Wheel, 11" x 3" Brakes		4	----	2260 549	2260 549
5-26-5	ANCHOR, Hold-Down Spring		8	2072 675		
<b>5-27-0 BRAKE PEDAL AND BUSHING</b>						
5-27-1	PEDAL, w/Manual Trans., w/o Power Brakes		1	2461 512		
	w/Auto. Trans., w/o Power Brakes		1	*2265 949		
	w/Manual Trans., w/Power Brakes	8	1	2467 728		
	w/Auto. Trans., w/Power Brakes	8	1	2467 732		
	w/Manual Trans., w/o Power Brakes, VP1, VP2, VD1, VD2		1	----	2460 332	
	w/Auto. Trans., w/o Power Brakes, VP1, VP2, VD1, VD2		1	----	2460 334	
	w/Manual Trans., w/Power Brakes, VP1, VP2, VD1, VD2		1	----	2460 338	
	w/Auto. Trans., w/Power Brakes, VP1, VP2, VD1, VD2		1	----	2405 106	
	w/o Power Brakes, VA3, VC1, VC2	8	1	----	2460 336	2460 336
	w/Power Brakes, VA3, VC1, VC2, VC3	8	1	----	2405 102	2405 102
	w/Power Brakes, VC2-300K	8	1	----	----	2460 336
	w/Power Brakes, VY1	8	1	----	----	2405 108
5-27-2	SLEEVE		1	2073 634		
	BUSHING		2	*2467 771	*2467 771	*2467 771
5-27-6	LOCK, Sleeve, except Taxi		1	2072 816		
	Taxi and Heavy Duty		1	2207 701		

★ Indicates use as required.

Numerals in parentheses ( ) refer to notes.

Printed in U.S.A.

Ⓜ Indicates parts not listed in any previous parts book.

Prices and specifications subject to change without notice.

March 15, 1965 Supersedes March 16, 1964.

Page 5-14

\* Indicates change or addition.

CODE	PART NAME AND DESCRIPTION	CYL	PER CAR	VALIANT DART	PLYMOUTH DODGE	CHRYSLER IMPERIAL
<b>5-27-O BRAKE PEDAL AND BUSHING - Cont'd</b>						
5-27-9	BRACE, Pedal Bracket to Dash, VP1, VP2, VD1, VD2 . . . . .		1	----	2162 795	
	Pedal Bracket to Windshield Frame, VA3, VC1, VC2, VC3 . . . . .	8	1	----	1901 801	1901 801
	Pedal Bracket to Lower Reinforcement, VA3 . . . . .	8	1	----	1901 788	
5-27-12	NUT, Pedal Sleeve Lock Screw . . . . .		1	2208 008		
5-27-21	BUSHING, Pedal Hub . . . . .		2	2072 822		
<b>5-28-O BRAKE PEDAL PAD</b>						
5-28-8	PAD, w/Manual Trans. . . . .		1	1731 228	1731 228	
	VA3, VC1, VC2 except 300K . . . . .	8	1	----	2405 088	2405 088
	w/Auto. Trans., VP1, VP2, VD1, VD2 . . . . .		1	2260 071	2260 071	
	VA3, VC1, VC2 except 300K, VC3 . . . . .	8	1	----	2405 082	2405 082
	VY1 . . . . .	8	1	----	----	2405 091
	VC2-300K w/Manual or Auto. Trans. . . . .	8	1	----	----	2405 088
<b>5-29-O BRAKE PEDAL SHAFT</b>						
5-29-1	SHAFT, w/Manual Trans., w/o Power Brakes, VC1, VC2 . . . . .		1	----	1730 009	1730 009
	w/Auto. Trans., w/o Power Brakes, VC1, VC2 . . . . .		1	----	1637 782	1637 782
	w/Power Brakes . . . . .		1	----	2405 105	2405 105
<b>5-30-O BRAKE PEDAL STOP</b>						
5-30-12	PIN, w/Power Brakes, VA3, VC1, VC2, VC3 . . . . .	8	1	----	2404 781	2404 781
<b>5-31-O BRAKE PEDAL BRACKET</b>						
5-31-11	REINFORCEMENT, w/o Power Brakes, VP1, VP2, VD1, VD2 . . . . .		1	----	2260 008	
	VA3, VC1, VC2 . . . . .	8	1	----	2260 705	2260 705
	w/Power Brakes, VP1, VP2, VD1, VD2 . . . . .		1	----	2401 405	
	VA3, VC1, VC2, VC3 . . . . .	8	1	----	2260 703	2260 703
	VY1 . . . . .	8	1	----	----	2260 069
5-31-12	GASKET, Reinforcement . . . . .		1	----	2260 016	2260 016
5-31-13	NUT, Pedal Bracket . . . . .		1	----	2076 232	2076 232
	Reinforcement, VC1, VC2, VC3 . . . . .		4	----	2076 232	2076 232
5-31-14	SPACER, Reinforcement to Master Cylinder, VC2-300K . . . . .	8	1	----	----	2401 861
5-31-15	BRACKET, Pedal, w/o Power Brakes, VC1, VC2 . . . . .		1	2266 779	2405 124	2405 124
	w/Power Brakes, except VC2-300K . . . . .		1	2266 779	2405 100	2405 100
	VC2-300K . . . . .	8	1	----	----	2405 124
<b>5-34-O BRAKE PEDAL RETURN SPRING</b>						
5-34-1	SPRING, w/o Power Brakes, VC1, VC2 . . . . .		1	2260 710	2260 710	2260 710
5-34-6	SEAT, Spring, w/o Power Brakes, VC1, VC2 . . . . .		1	2260 709	2260 709	2260 709
<b>5-39-O MASTER CYLINDER</b>						
5-39-1	REPAIR PACKAGE, Master Cylinder, w/o Power Brakes, w/o Piston, VC1, VC2 . . . . .		1	2196 905	2196 905	2196 905
	w/o Power Brakes, w/PISTON, VC1, VC2 . . . . .		1	2421 315	2275 516	2275 516
	w/Power Brakes, w/PISTON, except VC2-300K . . . . .		1	2298 939	2298 939	2298 939
	w/ or w/o Power Brakes, w/o Piston, VC2-300K . . . . .	8	1	----	----	*2196 905
	w/ or w/o Power Brakes, w/PISTON, VC2-300K . . . . .	8	1	----	----	*2275 516

\* Indicates use as required.

Numerals in parentheses ( ) refer to notes.

Printed in U.S.A.

⊠ Indicates parts not listed in any previous parts book.

Prices and specifications subject to change without notice.

• Indicates change or addition.

# 1964 PASSENGER CAR PARTS CATALOG

BRAKE-SERVICE

CODE	PART NAME AND DESCRIPTION	CYL	PER CAR	VALIANT DART	PLYMOUTH DODGE	CHRYSLER IMPERIAL
<b>5-39-0 MASTER CYLINDER - Cont'd</b>						
5-39-3	CYLINDER, Master, w/o Power Brakes, VC1, VC2 except 300K . . . . .		1	2421 353	2071 060	2071 060
	w/Power Brakes, except VC2-300K . . . . .		1	2275 519	2275 519	2275 519
	w/ or w/o Power Brakes, VC2-300K . . . . .		1	----	----	2401 863
5-39-11	BOLT, Mounting, w/o Power Brakes, VC1, VC2 . . . . .		4	----	2260 046	2260 046
5-39-12	WASHER, Cover Screw, VC2-300K . . . . .	8	1	----	----	1193 106
5-39-18	GASKET, Master Cylinder to Dash, w/o Power Brakes, VC1, VC2 . . . . .		1	2401 862	*2401 862	*2401 862
	w/ or w/o Power Brakes, VC2-300K . . . . .		1	----	----	*2401 862
	w/Power Brakes, Power Unit to Dash . . . . .		1	2401 862		
	w/Power Brakes, Power Unit to Master Cylinder . . . . .		1	2074 965		
5-39-20	COVER . . . . .		1	*2265 641	*2265 641	*2265 641
5-39-21	SCREW, Cover . . . . .		1	1556 675	1556 675	1556 675
5-39-24	GASKET, Cover . . . . .		1	2401 152	2401 152	2401 152
<b>5-40-0 MASTER CYLINDER BOOT</b>						
5-40-1	BOOT, w/o Power Brakes, VC1, VC2 . . . . .		1	1828 388	1828 388	1828 388
<b>5-44-0 MASTER CYLINDER PISTON</b>						
5-44-8	STOP, w/o Power Brakes . . . . .		1	1828 389	1828 389	1828 389
	w/Power Brakes . . . . .		1	1828 389	2265 635	2265 635
5-44-9	SCREW, Stop, w/Power Brakes . . . . .		2	132 259	2200 341	2200 341
<b>5-46-0 MASTER CYLINDER PISTON RETURN SPRING</b>						
5-46-1	SPRING . . . . .		1	1738 268	1738 268	1738 268
<b>5-47-0 MASTER CYLINDER PISTON PUSH ROD</b>						
5-47-4	BOLT, End . . . . .		1	2201 181	2201 181	2201 181
5-47-8	NUT, End Bolt . . . . .		1	2122 266	2122 266	2122 266
<b>5-52-0 MASTER CYLINDER BRAKE TUBE</b>						
5-52-3	NUT, Master Cylinder Brake Tube, Master Cylinder End . . . . .		1	1828 461	1828 461	1828 461
	Tee End . . . . .		1	1739 226	1739 226	1739 226
5-52-62	CONNECTOR . . . . .		1	1828 396	1828 396	1828 396
<b>5-53-0 BRAKE TUBING AND COVERS</b>						
5-53-3	TUBING, 25 Foot Roll, 3/16" O.D. . . . .		★	1843 251	1843 251	1843 251
	1/4" O.D. . . . .		★	1843 252	1843 252	1843 252
	5/16" O.D. . . . .		★	1843 253	1843 253	1843 253
	3/8" O.D. . . . .		★	1843 254	1843 254	1843 254
5-53-4	COVER, Tubing, 25 Foot Roll, for 3/16" O.D. Tubing . . . . .		★	1843 257	1843 257	1843 257
	For 1/4" O.D. Tubing . . . . .		★	1843 258	1843 258	1843 258
5-53-6	SHIELD, Brake Tube to Gearshift Control Cable, VP1, VP2, VD1, VD2 . . . . .		1	----	*1739 230	

★ Indicates use as required.

Numerals in parentheses ( ) refer to notes.

Printed in U.S.A.

⊃ Indicates parts not listed in any previous parts book.

Prices and specifications subject to change without notice.

March 15, 1965 Supersedes March 16, 1964.

\* Indicates change or addition.



CODE	PART NAME AND DESCRIPTION	CYL	PER CAR	VALIANT DART	PLYMOUTH DODGE	CHRYSLER IMPERIAL
<b>5-56-O BRAKE TUBE CLIP</b>						
5-56-2	CLIP . . . . .		★	----	2467 719	
			★	1119 423	1119 423	1119 423
			★	2123 341	2123 341	2123 341
			★	2207 933	2207 933	2207 933
<b>5-57-O BRAKE TUBE BRACKET</b>						
5-57-2	BRACKET, Front, VA3, VC1, VC2, VC3 . . . . .	8	2	----	1739 248	1739 248
	VY1 . . . . .	8	2	----	----	2123 212
	Rear, VP1, VP2, VD1, VD2 . . . . .		1	----	2208 892	
	VA3, VC1, VC2, VC3 . . . . .	8	1	----	2123 214	2123 214
<b>5-58-O BRAKE TUBE TEE</b>						
5-58-1	TEE, Master Cylinder Tube to Brake Tube, VP1, VP2, VD1, VD2 . . . . .		1	2208 853	2207 937	
	VA3, VC1, VC2 except 300K, VC3 . . . . .	8	1	----	2123 217	2123 217
	VC2-300K . . . . .	8	1	----	----	2074 069
	VY1 . . . . .	8	1	----	----	2123 218
	Rear Axle Tube, VP1, VP2, VD1, VD2 . . . . .		1	1940 621	1118 161	
	VA3, VC1, VC2, VC3 . . . . .	8	1	----	1940 622	1940 622
	VY1 . . . . .	8	1	----	----	2070 311
5-58-2	SCREW, Brake Tube Tee . . . . .		1	6023 133	6023 133	6023 133
5-58-5	SPACER, Rear Axle Brake Tube Tee, VY1 . . . . .	8	1	----	----	1940 447
<b>5-62-O BRAKE FLEXIBLE HOSE</b>						
5-62-1	HOSE, Front, VC1, VC2, VC3 . . . . .		2	2073 023	2208 495	2208 495
	VY1 . . . . .	8	2	----	----	2208 496
	Rear, VP1, VP2, VD1, VD2, VY1 . . . . .		1	1739 215	2207 918	1739 215
	VA3, VC1, VC2, VC3 . . . . .	8	1	----	1739 249	1739 249
5-62-7	GASKET, Front Wheel Hose . . . . .		2	2072 612	692 166	692 166
5-62-20	LOCK, Brake Hose to Bracket . . . . .		3	2208 893	2208 893	2208 893
<b>5-63-O WHEEL CYLINDER REPAIR PACKAGE</b>						
5-63-1	REPAIR PACKAGE, Wheel Cylinder, Front . . . . .		2	2084 788	2275 535	2275 535
	Rear, except VP1, VP2, VD1, VD2, Police . . . . .		2	2084 789	2275 536	2275 536
	Rear, VP1, VP2, VD1, VD2, Police . . . . .		2	----	2421 347	
5-63-3	REPAIR PACKAGE, Wheel Cylinder Piston, Front . . . . .		2	2084 790	2275 539	2275 539
	Rear, except VP1, VP2, VD1, VD2, Police . . . . .		2	2084 791	2275 540	2275 540
	Rear, VP1, VP2, VD1, VD2, Police . . . . .		2	----	2421 346	
<b>5-64-O WHEEL BRAKE CYLINDER</b>						
5-64-1	CYLINDER, Front, Right, VP1, VP2, VD1, VD2 . . . . .		1	2072 616	2265 362	
	Left, VP1, VP2, VD1, VD2 . . . . .		1	2072 617	2265 363	
	Right, VA3 . . . . .	8	1	----	2265 363	2265 363
	Left, VA3 . . . . .	8	1	----	2265 362	2265 362
	Rear . . . . .		2	*2072 632		
	Rear, 15/16" Dia., VP1, VP2, VD1, VD2, except Police, VA3 . . . . .		2	----	*2260 842	*2260 842
	Rear, 13/16" dia., VP1, VP2, VD1, VD2, Police and Heavy Duty . . . . .		2	----	*2401 930	
	Rear, 15/16" dia., VP1, VP2, VD1, VD2, Police and Heavy Duty . . . . .		2	----	*2260 842	
5-64-2	SCREW, Mounting, Front Wheel . . . . .		4	6023 963		
	Rear Wheel . . . . .		4	2072 615		
	Front and Rear Wheel . . . . .		8	----	2266 876	2266 876

★ Indicates use as required.

Numerals in parentheses ( ) refer to notes.

Printed in U.S.A.

⊠ Indicates parts not listed in any previous parts book.

Prices and specifications subject to change without notice.

\* Indicates change or addition.

# 1964 PASSENGER CAR PARTS CATALOG

CODE	PART NAME AND DESCRIPTION	C Y L	P E R C A R	VALIANT DART	PLYMOUTH DODGE	CHRYSLER IMPERIAL
<b>5-67-0 WHEEL CYLINDER BLEEDER SCREW</b>						
5-67-1	SCREW . . . . .		4	2072 658	2072 658	2072 658
<b>5-69-0 WHEEL CYLINDER BOOT</b>						
5-69-1	BOOT, Front Wheel . . . . .		4	2072 825	2260 840	2260 840
	Rear Wheel . . . . .		4	2072 679	2260 846	2260 846
<b>5-70-0 WHEEL CYLINDER PISTON</b>						
5-70-1	PISTON, Front Wheel . . . . .		4	2072 655	2260 837	2260 837
	Rear Wheel, VP1, VP2, VD1, VD2, except Police, VA3 . . . . .		4	2072 656	2260 843	2260 843
	Rear Wheel, VP1, VP2, VD1, VD2, Police and Heavy Duty . . . . .		4	----	2401 938	
<b>5-71-0 WHEEL CYLINDER PISTON CUP</b>						
5-71-1	CUP, Front Wheel . . . . .		4	1669 337	2260 838	2260 838
	Rear Wheel, VP1, VP2, VD1, VD2, except Police, VA3 . . . . .		4	2072 636	2260 844	2260 844
	Rear Wheel, VP1, VP2, VD1, VD2, Police and Heavy Duty . . . . .		4	----	2072 636	
5-71-2	SPRING, Front Wheel . . . . .		2	1923 765	2260 839	2260 839
	Rear Wheel, VP1, VP2, VD1, VD2, except Police, VA3 . . . . .		2	2072 637	1923 765	1923 765
	Rear Wheel, VP1, VP2, VD1, VD2, Police and and Heavy Duty . . . . .		2	----	2072 637	
<b>5-100-0 POWER BRAKE POWER UNIT</b>						
5-100-1	REPAIR PACKAGE, Power Unit, Bendix . . . . .		1	*2075 001		
	For Midland-Ross Factory Installed Power Unit, VC1, VC2, VC3 . . . . .		1	----	2495 069	2495 069
	Power Brake, Kelsey Hayes, VP1, VP2, VD1, VD2 . . . . .		1	----	*2525 437	
	Kelsey Hayes, VA3, VC1, VC2, VC3 . . . . .	8	1	----	E2525 438	E2525 438
	For Bendix Power Unit, VP1, VP2, VD1, VD2 . . . . .		1	----	2448 345	
	For Bendix Power Unit, VA3, VC1, VC2, VC3 . . . . .	8	1	----	2448 346	2448 346
	For Midland-Ross Field Installed Power Unit, VC1, VC2, VC3 . . . . .		1	----	2525 007	2525 007
	For Midland-Ross Power Unit, Minor Overhaul, VC2-300K . . . . .	8	1	----	----	2448 347
	For Midland-Ross Power Unit, Major Overhaul, VC2-300K . . . . .	8	1	----	----	2448 348
	RING PACKAGE, Power Brake Reaction, Midland Ross, VC1, VC2, VC3 . . . . .		1	----	E2585 325	E2585 325
5-100-2	POWER UNIT, Export . . . . .		1	*2401 865		
	Domestic . . . . .		1	*2467 584		
	VP1, VP2, VD1, VD2 . . . . .		1	----	*2525 427	
	VA3, VC1, VC2 except VC2-300K, VC3 . . . . .	8	1	----	E2525 428	E2525 428
	VC2-300K . . . . .	8	1	----	----	2201 098
	VY1 . . . . .	8	1	----	----	2409 224
5-100-4	DIAPHRAGM and PRESSURE PLATE, VC2-300K, Midland Ross . . . . .	8	1	----	----	*1267 503
	DIAPHRAGM, Power Piston, Kelsey Hayes . . . . .		1	----	*2530 011	*2530 011
5-100-5	RETAINER, Diaphragm, Export . . . . .		1	*2074 977		
5-100-7	SHELL, Power Unit, Rear, Export . . . . .		1	*2409 203		
	Front . . . . .		1	2074 990		
	COVER and STUDS, Kelsey Hayes . . . . .		1	----	*2530 030	*2530 030

★ Indicates use as required.

Numerals in parentheses ( ) refer to notes.

Printed in U.S.A.

⊠ Indicates parts not listed in any previous parts book.

Prices and specifications subject to change without notice.

March 15, 1965 Supersedes March 16, 1964.

\* Indicates change or addition.

CODE	PART NAME AND DESCRIPTION	CYL	PER CAR	VALIANT DART	PLYMOUTH DODGE	CHRYSLER IMPERIAL
<b>5-100-0 POWER BRAKE POWER UNIT - Cont'd</b>						
5-100-9	HOUSING and STUDS, Front, Kelsey Hayes . . . . .		1	----	*2530 024	*2530 024
5-100-15	SPRING, Piston Return, VC2-300K . . . . .		1	2074 999	----	2401 877
5-100-17	GASKET, Hydraulic Cylinder, VC2-300K . . . . .	8	1	----	----	1502 557
5-100-19	BLOCK, Push Rod Vee, VC2-300K, Midland Ross. SEAL, Guide, Kelsey Hayes . . . . .	8	2 1	----	----	*1502 556 *2530 025
5-100-20	ROD, Push, Export . . . . . VC1, VC2 except 300K, VC3 . . . . .		1 1	*2074 998 *2074 998	*2409 998	*2409 998
5-100-22	SCREW, Front Housing Spacer . . . . . Front to Rear Housing . . . . .		2 10	----	2401 856 2401 173	2401 856 2401 173
5-100-26	GUARD, Push Rod, Export . . . . . Domestic . . . . . BOOT, Push Rod, VC1, VC2 except 300K, VC3, Midland Ross . . . . . Bendix . . . . .		1 1 1 1	*2074 987 *2467 592 ----	*2401 165 ----	*2401 165 *2401 134
5-100-31	RING, Push Rod to Diaphragm Collar Snap, VC2-300K . . . . .	8	1	----	----	1191 144
5-100-32	RETAINER, Push Rod, VC1, VC2, VC3, Midland Ross . . . . . Housing to Guide Seal, Kelsey Hayes . . . . .		1 1	----	*2401 166 *2530 026	*2401 166 *2530 026
5-100-33	PISTON, VC2-300K, Midland Ross . . . . . Control, VP1, VP2, VD1, VD2, Kelsey Hayes . . Power, Kelsey Hayes . . . . .	8	1 1 1	----	----	*1287 509 *2530 011 *2530 003
5-100-43	CUP, Slave Cylinder, VC2-300K . . . . .	8	1	----	----	1267 510
5-100-47	PLATE, Piston, Front . . . . .		1	2071 082		
5-100-53	WASHER, Hydraulic Cylinder End Cap, VC2-300K.	8	1	----	----	1191 159
5-100-62	SCREW, Push Rod, VC1, VC2, VC3, Midland Ross . . . . . SCREW, Power Piston to Control Piston, Kelsey Hayes . . . . .		1 1	----	*2401 852 *2530 012	*2401 852 *2530 012
5-100-85	SPRING, Breather Control Piston, VC2-300K . . .	8	1	----	----	2401 876
5-100-86	INSERT, Reaction Ring, Kelsey Hayes . . . . .		1	----	*2530 008	*2530 008
5-100-87	RING, Two Stage Reaction, Midland Ross . . . . . Reaction, Kelsey Hayes . . . . .		1 1	----	E2534 351 *2530 007	E2534 351 *2530 007
5-100-88	PLATE, Reaction, VP1, VP2, VD1, VD2, Kelsey Hayes . . . . . VA3, VC1, VC2, VC3, Kelsey Hayes . . . . .		1 1	----	*2530 006 E2530 038	E2530 038
5-100-90	ADAPTER, VC1, VC2, VC3 . . . . .		1	----	2401 170	2401 170
5-100-91	SEAL, Adapter to Rear Housing, VC1, VC2, VC3 . Adapter to Hub, VC1, VC2, VC3 . . . . . Hub to Diaphragm Backing Plate, VC1, VC2, VC3		1 1 1	----	2401 163 2401 171 2409 997	2401 163 2401 171 2409 997
5-100-92	RING, Adapter Snap, VC1, VC2, VC3 . . . . .		1	----	2401 164	2401 164
5-100-94	CONNECTOR, Vacuum Hose, VC1, VC2, VC3 . . .		1	----	2401 159	2401 159

\* Indicates use as required.

E Indicates parts not listed in any previous parts book.

• Indicates change or addition.

Numerals in parentheses ( ) refer to notes.

Prices and specifications subject to change without notice.

March 15, 1965 Supersedes March 18, 1964.

# 1964 PASSENGER CAR PARTS CATALOG

BRAKE-SERVICE

CODE	PART NAME AND DESCRIPTION	CYL	PER CAR	VALIANT DART	PLYMOUTH DODGE	CHRYSLER IMPERIAL
<b>5-100-0 POWER BRAKE POWER UNIT - Cont'd</b>						
5-100-95	WASHER, Vacuum Hose Connector, VC1, VC2, VC3		1	----	2401 857	2401 857
5-100-105	REINFORCEMENT, Brake Pedal Bellows, at Dash Panels, VY1	8	1	----	----	2217 843
5-100-119	DISC, Reaction, VY1	8	1	----	----	2409 990
5-100-134	SEAL, Floating Valve, Kelsey Hayes		1	----	*2530 023	*2530 023
5-100-142	GUIDE, Power Piston, Kelsey Hayes		1	----	*2530 010	*2530 010
5-100-152	PACKING KIT, Piston		1	2075 000		
5-100-154	BLOCK, Breather Control Piston Vee, VC2-300K	8	1	----	----	1193 701
5-100-155	"O" RING, Breather Control Valve, VC2-300K	8	1	----	----	2401 873
5-100-157	PLATE PACKAGE, Diaphragm and Piston		1	2240 625		
5-100-161	SEAL, Plunger Sleeve, VC1, VC2, VC3, Midland Ross	8	1	----	*2401 172	*2401 172
	Reaction Hub, VY1, Midland Ross	8	1	----	----	*2266 942
	Valve Body, Midland Ross	8	1	----	----	*2401 126
	Control Piston "O" Ring, Kelsey Hayes		1	----	*2530 017	*2530 017
	Power Piston "O" Ring, Kelsey Hayes		1	----	*2530 005	*2530 005
	Cover to Power Piston, Kelsey Hayes		1	----	*2530 031	*2530 031
5-100-166	PLUNGER, Vacuum Valve, Export		1	*2074 981		
	Domestic		1	*2467 618		
	RETAINER and PLUNGER PACKAGE, Push Rod, Factory Installed, VC1, VC2, VC3		1	----	2495 066	2495 066
	Field Installed, VC1, VC2, VC3		1	----	2448 745	2448 745
5-100-167	BUSHING, Push Rod to Plunger, VC1, VC2, VC3		2	----	2401 853	2401 853
5-100-169	ROD, Valve Operating, Export		1	*2074 997		
	Domestic		1	*2467 597		
5-100-185	CLEANER, Air, w/TUBE, Export		1	*2074 992		
	TUBE, Vacuum, w/BRACE, Domestic		1	*2467 596		
5-100-189	HUB, w/LEVERS		1	2074 985		
5-100-190	LINK, Pedal		1	2074 989		
5-100-191	PIN, Lever Pivot, Export		1	*2074 986		
5-100-192	WASHER, Bowed, Export		2	*2075 005		
	Domestic		2	*2467 600		
5-100-193	SPRING, Valve Return Export		1	*2074 980		
	Domestic		1	*2530 001		
5-100-194	PIN, Clevis		2	2075 006		
5-100-195	RING, Diaphragm Retaining, VC1, VC2, VC3		1	----	2401 161	2401 161
	Lever Retaining, VC1, VC2, VC3, Midland Ross		1	----	*2401 858	*2401 858
5-100-196	SPRING, Poppet Return		1	2074 979		
5-100-197	SILENCER, Valve Body, VY1	8	1	----	----	2401 154
5-100-206	PLATE, Mounting		1	2074 988		
5-100-210	RETAINER, Front Shell Seal, VY1	8	1	----	----	*2401 885

\* Indicates use as required.

Numerals in parentheses ( ) refer to notes.

Printed in U.S.A.

E Indicates parts not listed in any previous parts book.

Prices and specifications subject to change without notice.

March 15, 1965 Supersedes March 16, 1964.

\* Indicates change or addition.

CODE	PART NAME AND DESCRIPTION	CYL	PER CAR	VALIANT DART	PLYMOUTH DODGE	CHRYSLER IMPERIAL
<b>5-100-O POWER BRAKE POWER UNIT - Cont'd</b>						
5-100-212	GROMMET, Vacuum Connector to Front Housing VC1, VC2, VC3 . . . . .		1	----	2467 576	2467 576
	By-Pass Tube, VC2-300K . . . . .	8	1	----	----	1923 484
5-100-242	"O" RING, Push Rod Bushing, VC2-300K . . . . .	8	1	----	-----	1502 565
	Hydraulic Cylinder to Front Chamber, VC2-300K	8	1	----	-----	1502 566
5-100-299	NUT, Breather Control Diaphragm Plate, VC2-300K . . . . .	8	1	----	-----	1506 248
5-100-304	SEAL, Breather Control Piston, VC2-300K . . . . .	8	1	----	-----	1502 559
<b>5-101-O POWER UNIT MOUNTING BRACKET</b>						
5-101-1	BRACKET, Mounting, VC2-300K . . . . .	8	1	----	-----	2201 089
5-101-5	REINFORCEMENT, Bracket, VC2-300K . . . . .	8	1	----	-----	2401 911
5-101-6	GASKET, Reinforcement, VC2-300K . . . . .	8	1	----	-----	2401 913
<b>5-102-O POWER BRAKE VACUUM TANK</b>						
5-102-2	TANK . . . . .		1	2201 905*		
5-102-11	NUT, Mounting . . . . .		2	2076 232		
<b>5-105-O POWER BRAKE VACUUM CHECK VALVE</b>						
5-105-1	VALVE, Check, Midland Ross . . . . .		1	*2074 934		
	Factory Installed Power Unit, Midland Ross, VC1, VC2, VC3 . . . . .		1	----	*2495 067	*2495 067
	Field Installed Power Unit, Midland Ross, VC1, VC2, VC3 . . . . .		1	----	*2421 083	*2421 083
	Kelsey Hayes . . . . .		1	----	*2530 032	*2530 032
	VC2-300K, Midland Ross . . . . .	8	1	----	----	*2401 870
	VY1, Midland Ross . . . . .	8	1	----	----	*2409 211
5-105-6	GROMMET, Check Valve, Kelsey Hayes . . . . .		1	----	*2530 033	*2530 033
5-105-10	WASHER, Check Valve, VC2-300K . . . . .	8	1	----	----	2401 871
	VY1 . . . . .	8	1	----	----	2401 132
<b>5-110-O POWER BRAKE HOSE CONNECTOR</b>						
5-110-18	CONNECTOR, Single . . . . .		1	1944 154		
	2 Way, VC1, VC2, VC3 . . . . .		1	----	1944 092	1944 092
	3 Way, VC1, VC2, VC3 . . . . .		1	----	1948 838	1948 838
	4 Way, VC3 Luxury New Yorker . . . . .	8	1	----	----	2460 416
	2 Way, VY1 . . . . .	8	1	----	----	2405 466
<b>5-111-O POWER BRAKE VACUUM HOSE</b>						
5-111-17	HOSE, (11/32" I.D. - sold by the inch) . . . . .		*	883 031	883 031	883 031
	(1/2" I.D. - sold by the inch) VC2-300K . . . . .	8	*	----	----	1671 650
<b>5-112-O POWER BRAKE HOSE CLAMP</b>						
5-112-1	CLAMP, Worm Gear Type, 5/8" to 1 3/8" . . . . .		*	2448 770	2448 770	2448 770

\* Indicates use as required.

Numerals in parentheses ( ) refer to notes.

Printed in U.S.A.

E Indicates parts not listed in any previous parts book.

Prices and specifications subject to change without notice.

\* Indicates change or addition.

# 1964 PASSENGER CAR PARTS CATALOG

BRAKE SERVICE

CODE	PART NAME AND DESCRIPTION	CYL	PER CAR	VALIANT DART	PLYMOUTH DODGE	CHRYSLER IMPERIAL
<b>5-113-O POWER BRAKE AIR CLEANER</b>						
5-113-17	FILTER, For Factory Installed Power Unit, VC1, VC2, VC3, Midland Ross . . . . .		1	----	*2467 575	*2467 575
	For Field Installed Power Unit, VC1, VC2, VC3 VY1 . . . . .		1	----	2401 855	2401 855
	AIR CLEANER, Kelsey Hayes . . . . .	8	1	----	----	2401 155
	Control Piston Push Rod Air, Kelsey Hayes . . .		1	----	*2530 027	*2530 027
	BREATHER, VC2-300K . . . . .	8	1	----	*2530 020	*2530 020
					----	2201 099
5-113-20	HUB, Filter Retainer, for Factory Installed Power Unit, VC1, VC2, VC3 . . . . .		1	----	2467 578	2467 578
5-113-21	COVER, Filter, for Factory Installed Power Unit, VC1, VC2, VC3 . . . . .		1	----	2467 577	2467 577
5-113-23	PLATE, Air Cleaner Filter, Kelsey Hayes . . . .		1	----	*2530 026	*2530 026

\* Indicates use as required.

Numerals in parentheses ( ) refer to notes.

Printed in U.S.A.

□ Indicates parts not listed in any previous parts book.

Prices and specifications subject to change without notice.

\* Indicates change or addition.